



ATHENS COUNTY ENGINEER'S OFFICE

Jeff Maiden, P.E., P.S., Athens County Engineer
16000 Canaanville Road Athens, Ohio 45701
Office (740) 593-5514 • Fax (740) 592-4616

ADDENDUM #1—SEPTEMBER 12, 2014

SALT/GRIT STORAGE STRUCTURES PROJECT PROJECT NO. 14051 ATHENS COUNTY, OHIO

1. See attached drawing “Addendum #1 – Revised Site Plan” enclosed. This drawing shows a new proposed location for the buildings and a revised grading plan. The buildings were moved away from the hillside and more centrally located in the flat pad area.
2. See attached drawing “Addendum #1- Wall Details” enclosed. The “Type A” waterproofing at the exterior of the concrete walls is deleted from this project. The interior joint has been changed to ½” preformed expansion joint filler with backer rod and joint sealant.
3. The subgrade for the building pad will be graded from 671.84 at the rear of the building, to 671.34 at the front of the building by Athens County Engineer’s employees at a tolerance of +/- 0.1 feet. The Contractor will be responsible for excavating for the footers, installing footers and walls, and backfilling the excavations. The Contractor will establish final grades for a distance of 10’ around the buildings. The Athens County Engineer’s office will provide final grading for the remainder of the site.
4. The ODOT 2-3 catch basin and 86 feet of 12” diameter storm sewer has been deleted.
5. The footer drains shall be extended to the ditch located about 60 feet from the rear of the buildings.

6. The roof structure specifications are amended as follows:

- The roof structure shall be the Winkler Canvas Limited, 60' wide by 98' deep three sided arch (Truss Free Standing Quonset), or approved equal. The roof structure shall be designed to be set on and attached to a reinforced concrete retaining wall structure.
- The minimum truss height shall be 26'-0" above top of concrete wall, resulting in a minimum height above floor slab of 35'-6".
- Trusses to be manufactured utilizing Gatorshield Galvanized Tubing as manufactured by Allied Mechanical Tube Division or approved equal.
- Each building shall have one open endwall, and one closed endwall (*that is vented*).
- The manufacturer of the roof structure shall provide structural drawings and connection details at top of concrete wall that complies with the 2011 Ohio Basic Building Code, and shall be stamped by a Professional Engineer registered in the State of Ohio.
- The roof structure/ building system is to be designed to meet a minimum snow load of 25 pounds per square foot, and wind load resulting from a 90 mph wind.
- The building shall have eleven (11) rows of rigid "X" bracing between trusses (i.e., rigid bracing from the top chord of one truss to the bottom chord of an adjacent truss, and from the bottom chord of one truss to the top chord of an adjacent truss.)

**THIS ADDENDUM MUST BE ACKNOWLEDGED ON PAGE 14 OF
"SECTION I" OF THE BID DOCUMENTS (BID FORM).**

SUBMITTED BY:



JEFF MAIDEN, PE, PS
ATHENS COUNTY ENGINEER

Z:\PROJECTS\Capital Improvements 2014\Engineers Salt Storage\dwg\Rebid_alt2.dwg 12-Sep-14 1:33 PM

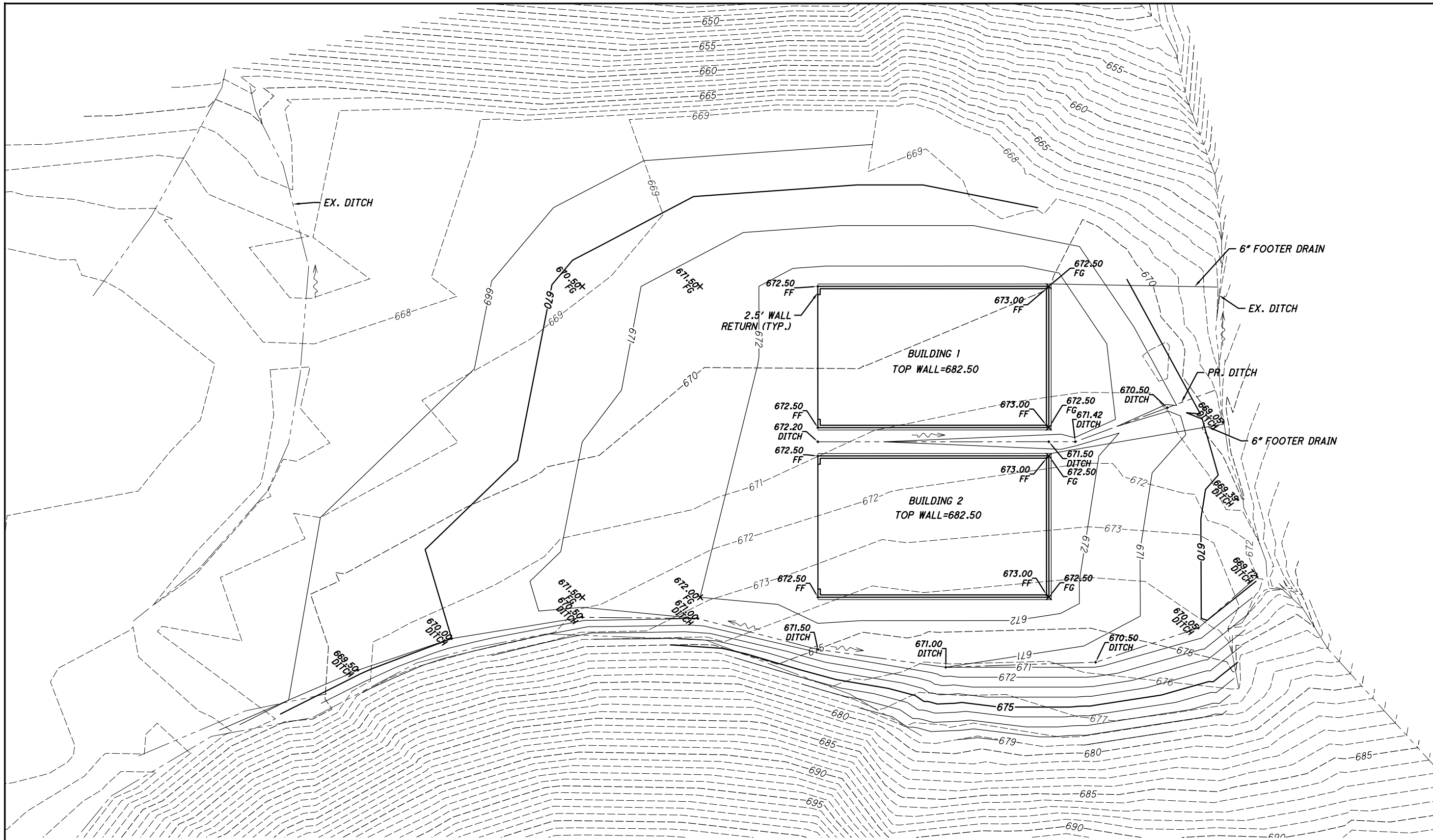

CALCULATED DES CHECKED RJM

0 20 40
HORIZONTAL SCALE IN FEET

ADDENDUM #1 - REVISED SITE PLAN

SALT/GRIT STORAGE STRUCTURES PROJECT

CONSTRUCTION NOTES

1. ATHENS COUNTY FORCES WILL PREPARE THE BUILDING SUBGRADE TO WITHIN ± 0.01' OF THE ELEVATION OF THE BOTTOM OF GRANULAR SUB BASE FOR THE CONCRETE SLAB.
2. CONTRACTOR SHALL EXCAVATE AND CONSTRUCT THE FOOTERS AND WALL AND SHOULD ONLY HAVE TO DO MINIMAL GRADING BEFORE PLACING STONE AND CONSTRUCTING THE CONCRETE PAD.
3. CONTRACTOR SHALL PROVIDE AND PLACE THE GRANULAR BACKFILL AND FOOTER DRAIN THEN BACKFILL UP TO THE LEVEL OF THE FLOOR SLAB. THE CONTRACTOR SHALL ESTABLISH FINAL GRADES FOR A DISTANCE OF 10' AROUND THE BUILDINGS.
4. ATHENS COUNTY FORCES WILL PROVIDE FINAL GRADING FOR THE REMAINDER OF THE SITE INCLUDING DITCHES AS WELL AS THE SEEDING AND MULCHING.

ENGINEER'S SEAL



SIGNED: *Rex Jeffrey Maiden*
 DATE: *8/9/12/14*

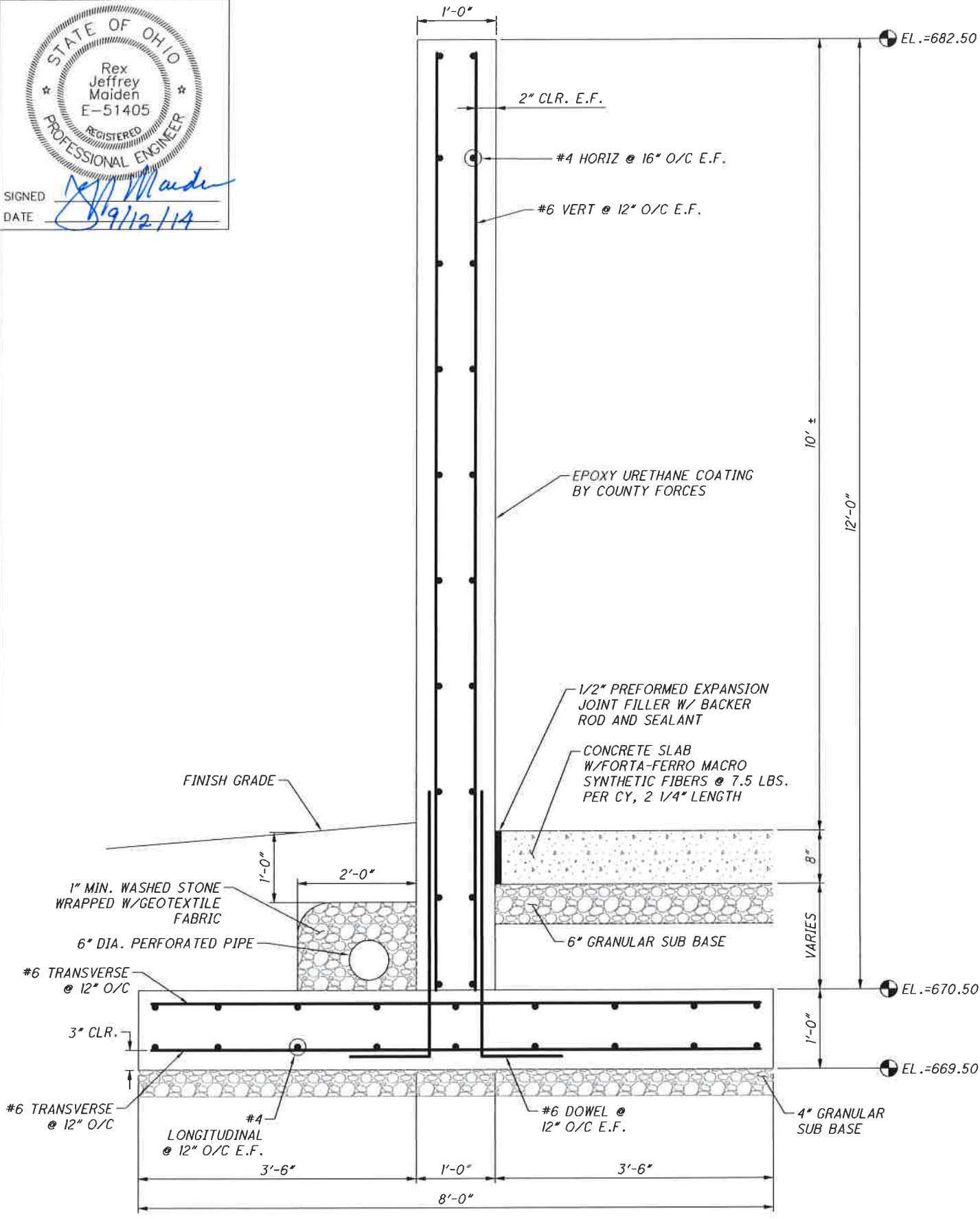

CALCULATED
DES
CHECKED
RJM

ADDENDUM #1 - WALL DETAILS

SALT/GRIT STORAGE STRUCTURES PROJECT