

**ATHENS COUNTY
ENGINEER'S OFFICE
2017**

**SALT/GRIT STORAGE
STRUCTURE PROJECT**

**PROJECT NO. 15070
ATHENS COUNTY, OHIO**

**BID NOTICE
SPECIFICATIONS
PROPOSAL
CONTRACT**



ATHENS COUNTY ENGINEER:
Jeff Maiden, P.E., D.S.

ATHENS COUNTY COMMISSIONERS:
Lenny Eliason
Chris Chmiel
Charles Adkins

ATHENS COUNTY AUDITOR:
Jill A. Thompson

BID OPENING: 10:00 am., Tuesday, August 15, 2017

**LOCATION: ATHENS COUNTY COMMISSIONER'S OFFICE
15 S. COURT STREET, ATHENS OHIO 45701**

BID SUBMITTED BY: _____
(Company)

STREET _____

CITY _____

STATE _____ **ZIP CODE** _____

PHONE _____ **FAX** _____

INDEX

<u>Page</u>	<u>Description</u>
 <u>SECTION I</u>	
1	COVER SHEET
2	INDEX
3	NOTICE TO BIDDERS
4-5	INFORMATION TO BIDDERS
6-8	SPECIFICATIONS FOR SALT/GRIT STORAGE STRUCTURE
9	BUILDING SITE PLAN
10	FOUNDATION AND WALL DETAIL
11-12	SPECIAL PROCEDURE SUBMITTAL
13	CURING METHODS
13	RESOURCES AND EXPERIENCE OF BIDDER
14	BID FORM
15	PROPOSAL BINDER
16	CERTIFICATION AGAINST DEBARMENT AND SUSPENSION
17	BID AFFIDAVIT
18	NON-COLLUSION AFFIDAVIT
19	NON-DELIQUENCY OF PERSONAL PROPERTY TAXES AFFIDAVIT
20	NO FINDINGS FOR RECOVERY AFFIDAVIT
21-22	BID GUARANTY AND CONTRACT BOND
23	INSTRUCTIONS FOR COMPLETION OF THE BID GUARANTY & CONTRACT BOND
24	CONTRACT
25	CERTIFICATE OF PROSECUTING ATTORNEY & COUNTY AUDITOR
26	CERTIFICATE OF COUNTY COMMISSIONERS & ENGINEER
 <u>SECTION II</u>	
	COUNTY GENERAL CONDITIONS
 <u>SECTION III</u>	
	WAGE RATES

NOTICE TO BIDDERS

Sealed bids for the SALT/GRIT STORAGE STRUCTURE PROJECT will received by the Board of County Commissioners of Athens County, Ohio, at their office, 15 S. Court Street, Athens Ohio until 10:00 a.m., Prevailing Local Time on the 15th day of August, 2017 and at that time and place will be publicly opened and read aloud. All bids will be considered valid until 60 days after the opening date, although not accepted or rejected.

The work for which proposals are invited consists of the CONSTRUCTION of a SALT/GRIT STORAGE STRUCTURE approximately 60'x70' in size and other miscellaneous work related to the construction of the SALT/GRIT STORAGE STRUCTURE PROJECT. The Engineer's Estimate of Construction Cost for this project is \$ 200,000.

Copies of the Construction Plans, Bidding Forms, and Specifications for the Contract may be purchased from the Office of the Athens County Engineer, 16000 Canaanville Rd, Athens, Ohio 45701 during regular business hours (7:00 a.m. to 3:30 p.m. Monday through Friday). A non-refundable fee of \$30.00 will be charged.

Each bid shall have filed with it a bid guaranty in the form of a certified check, cashier's check, or letter of credit revocable only at the option of Athens County in an amount equal to 10% of the bid or a bond in accordance with division (B) of Section 153.54 of the Revised Code.

Each proposal must contain the full name of the party or parties submitting the proposal and all persons interested therein. Each bidder must submit evidence of its experiences on projects of similar size and complexity. The owner intends and requires that this project be completed no more than 90 days after the notice to proceed is issued.

All contractors and subcontractors involved with the project will to the extent practicable use Ohio products, materials, services, and labor in the implementation of their project. Additionally, contractor compliance with the equal employment opportunity requirements of Ohio Administrative Code Chapter 123 is required.

Bidders must comply with the prevailing wage rates on Public Improvements in Athens County as determined by the Ohio Department of Commerce, Bureau of Wage and Hour Administration, 614.644.2239.

The Board of County Commissioners of Athens County, Ohio reserves the right to reject any and/or all bids and to waive informalities as may be in the best interest of Athens County.

Jeff Maiden, P.E., P.S.
Athens County Engineer

Advertising dates: 7/30/17, 8/6/17

INFORMATION TO BIDDERS

The completion date for this project is November 3, 2017.

The Construction and Materials Specifications as set forth in the latest issue of the "State of Ohio, Department of Transportation, Construction and Materials Specifications" (ODOT CMS- January 1, 2013 version) and all supplemental specifications thereto, not otherwise provided for in the General Specifications herein, are incorporated herein by reference. Where a conflict exists between these specifications and the ODOT CMS, the plans and these specifications shall govern. Sections 102 and 103 of the ODOT CMS do not apply. The terms "engineer" or "county" shall be substituted as appropriate where the ODOT CMS refers to the "department".

Section 108- Prosecution and Progress- of the ODOT CMS applies to this contract and has been included in the contract specifications. Contractors should be familiar with the sections related to Extension of Time (108.06) and Liquidated Damages (108.07). If the successful bid is between \$0 and \$500,000, then the liquidated damages will be \$500 per day. IF the successful bid is between \$500,000 and \$2,000,000, then the liquidated damages will be \$1000 per day.

The minimum wage to be paid to all labor employed on this contract on site shall be in accordance with the "Schedule of Prevailing Hourly Wage Rates" ascertained and determined by the State of Ohio, Department of Industrial Relations, applicable to public improvements in Athens County for road and bridge construction in accordance with Sections 4115.03 and 4115.16 of the Ohio Revised Code.

Performance Bonds shall be made with Athens County, Ohio as obligee.

If the successful bidder has filed a bid guaranty in the form of a certified check, cashier's check, or letter of credit, then at the time of entering the contract, the bidder shall file a performance bond in accordance with division (C) of Section 153.54 of the Revised Code and in substantially the form provided in Section 153.57 of the Revised Code.

All proposal guaranties will be returned immediately following the opening of proposals except those of the lowest three (3) bidders. These guaranties will be returned within ten (10) days following award of the contract, except that of the successful bidder that will be returned after satisfactory contract bond has been furnished and the contract has been executed.

The bidder shall sign the Proposal correctly. Proposals made by an individual, shall show his name and mailing address. Proposals made by a firm or a partnership shall show the name and mailing address of each member of the firm or partnership. If made by a corporation the Proposal must show the name of the state under the laws of which the corporation was chartered and the name and title of officer or officers having authority under the by-laws to sign contracts. Anyone signing the proposal as agent must file with it, legal authority to do so. The proposal submitted by the Bidder will be considered by the Board of County Commissioners as being his lowest responsive and responsible bid, in accordance with Revised Code Section 9.312, and shall not be subject to change or alteration after submission.

Bidders shall submit all pages in Section I in a sealed envelope with name, address, and bid time marked outside along with the following: "SALT/GRIT STORAGE STRUCTURE PROJECT". The County

Commissioners reserve the right to increase or decrease any quantities, waive any informalities or technicalities, and may reject any/or all bids as may be deemed to be in the best interest of Athens County.

For Review Only
Official Bid Packet available at
Athens County Engineer's Office

SPECIFICATIONS FOR SALT/GRIT STORAGE STRUCTURE

GENERAL

The project consists of the CONSTRUCTION of a cast in place concrete foundation and walls with a fiber reinforced concrete slab, to be built at the location shown on the site plan, near 16000 Canaanville Road Athens, Ohio 45701.

DESIGN AND PERMITS

The engineering design of the building will be provided by the Athens County Engineer. The Athens County Engineer shall acquire and pay for the State of Ohio Building permits.

SITE PREPARATION

The County will have the site ready for the Contractor to excavate for footers. The County will provide limited construction staking by establishing the four corners of each building, and benchmark for vertical control. It is the Contractor's responsibility to provide the offset stakes to hold the building corners and to establish lines for footers, etc.

ROOF STRUCTURE

The roof structure is not part of this contract. However, the contractor shall take care in placing rebar around the proposed connection plates for the roof structure. The County will provide the brace layouts for the contractor to assure the wall rebar will not interfere with the roof connection plates.

FOUNDATION

The wall detail drawing shall be considered final design as certified by the Athens County Engineer. Porous backfill, 2 feet thick, shall extend up to the plane of the subgrade, to 1 foot below the embankment surface, and laterally to the ends of the walls. A 6" diameter perforated plastic pipe shall be installed the full length of the footer. The outlet pipes between the footer and the ditch shall be 6" corrugated solid plastic pipe.

WALLS

Walls shall be such that the top elevation is 680.00. The structure shall be 3 sided with wall returns of 2'-6" at each open end (see building layout on grading plan). Once the wall forms are removed, the wall surfaces shall be flat and shall receive a "Rubbed Surface" per 2013 ODOT CMS 511.15. The contractor shall then install footer drains, waterproof the exterior walls, and backfill to the extent required with washed gravel. The footer drains shall be run to the ditch approximately 30 feet behind the structure. The County will paint/seal interior walls with an approved epoxy-urethane treatment prior to filling the structure with salt and/or grit mix.

FLOOR SLAB

The concrete slabs shall be 8" thick and reinforced with FORTA-FERRO macro synthetic fibers @ 7.5 lbs per cubic yard, 2 1/4" length. The interior slab of the building shall be made in one pour. Care must be taken with regards to possible sub-grade restraint (slip sheets), edge and/or grade-stake restraints, adequate curing, wind breaks if needed and sufficient saw-cut depth to create joint activation if a crack occurs. Joints shall be

cleaned and sealed. The concrete slab shall be sloped 1/16" per ft. back to front as shown on the typical drawing.

CONCRETE

Concrete shall be ODOT class "C" with epoxy coated reinforcing steel. IPANEX, a waterproofing compound, shall be used in all concrete, at the amounts recommended by the manufacturer. The material shall be supplied by the contractor which shall add the material to the ready mix trucks at the jobsite. All concrete shall be ordered with a 3" slump and 4% air. Once the concrete has a 3" slump prior to the addition of IPANEX, no additional water is to be added. It should be noted that the addition of IPANEX increases the slump and air of the mix, greatly increasing the workability of the concrete. The wall surfaces shall be flat and shall receive a "Rubbed Surface" per 2013 ODOT CMS 511.15.

PAYMENT

This project is bid as a lump sum. Any overruns in variable items such as concrete, etc. where a change in plan dimension is not first approved by a change order is the responsibility of the contractor. The contractor may submit invoices every 2 weeks for percentage work items completed based on a schedule of values.

SCHEDULE OF VALUES

The successful bidder shall submit an itemized schedule of values for items of work. The schedule of values should include (1) Mobilization (2) Construction Layout Stakes (3) Excavation for footers (4) Reinforcing Steel- Epoxy Coated (5) Concrete Footers (6) Concrete Walls (7) Exterior Waterproofing (8) Porous Backfill and Footer Drains (9) Concrete Slabs (10) Final Grading (11) Performance Bond.

BUILDING DETAILS

The wall detail drawing shall be considered final design as certified by the Athens County Engineer.

RAIN GUTTERS

Bidder may submit a separate cost for the addition of rain gutters on each side of the Structure for consideration. However, this cost is NOT to be included in the lump sum bid for the structure.

PREVAILING WAGE

Prevailing wages must be paid in conformance with Ohio Law.

PRECONSTRUCTION MEETING

A preconstruction meeting will be scheduled after the project is awarded. The contractor's representative that attends the meeting should have the authority to sign contracts at this meeting. The successful contractor shall bring the following information to this meeting:

- (1) Cost Breakdown/ Schedule of Values for items of work (see above)
- (2) List of Material Suppliers
- (3) List of Subcontractors
- (4) Superintendent and Project Manager's Contact Information
- (5) Project Schedule (showing critical path to completion)

ODOT CMS AND LIQUIDATED DAMAGES

The Construction and Materials Specifications as set forth in the latest issue of the "State of Ohio, Department of Transportation, Construction and Materials Specifications" (ODOT CMS- January 1, 2013 version) and all supplemental specifications thereto, not otherwise provided for in the General Specifications herein, are incorporated herein by reference. Where a conflict exists between these specifications and the ODOT CMS, the plans and these specifications shall govern. Sections 102 and 103 of the ODOT CMS do not apply. The terms "engineer" or "county" shall be substituted as appropriate where the ODOT CMS refers to the "department".

Section 108- Prosecution and Progress- of the ODOT CMS applies to this contract. Contractors should be familiar with the sections related to Extension of Time (108.06) and Liquidated Damages (108.07). If the successful bid is between \$0 and \$500,000, then the liquidated damages will be \$500 per day. If the successful bid is between \$500,000 and \$2,000,000, then the liquidated damages will be \$1000 per day.

*For Review Only
Official Bid Packet available at
Athens County Engineer's Office*

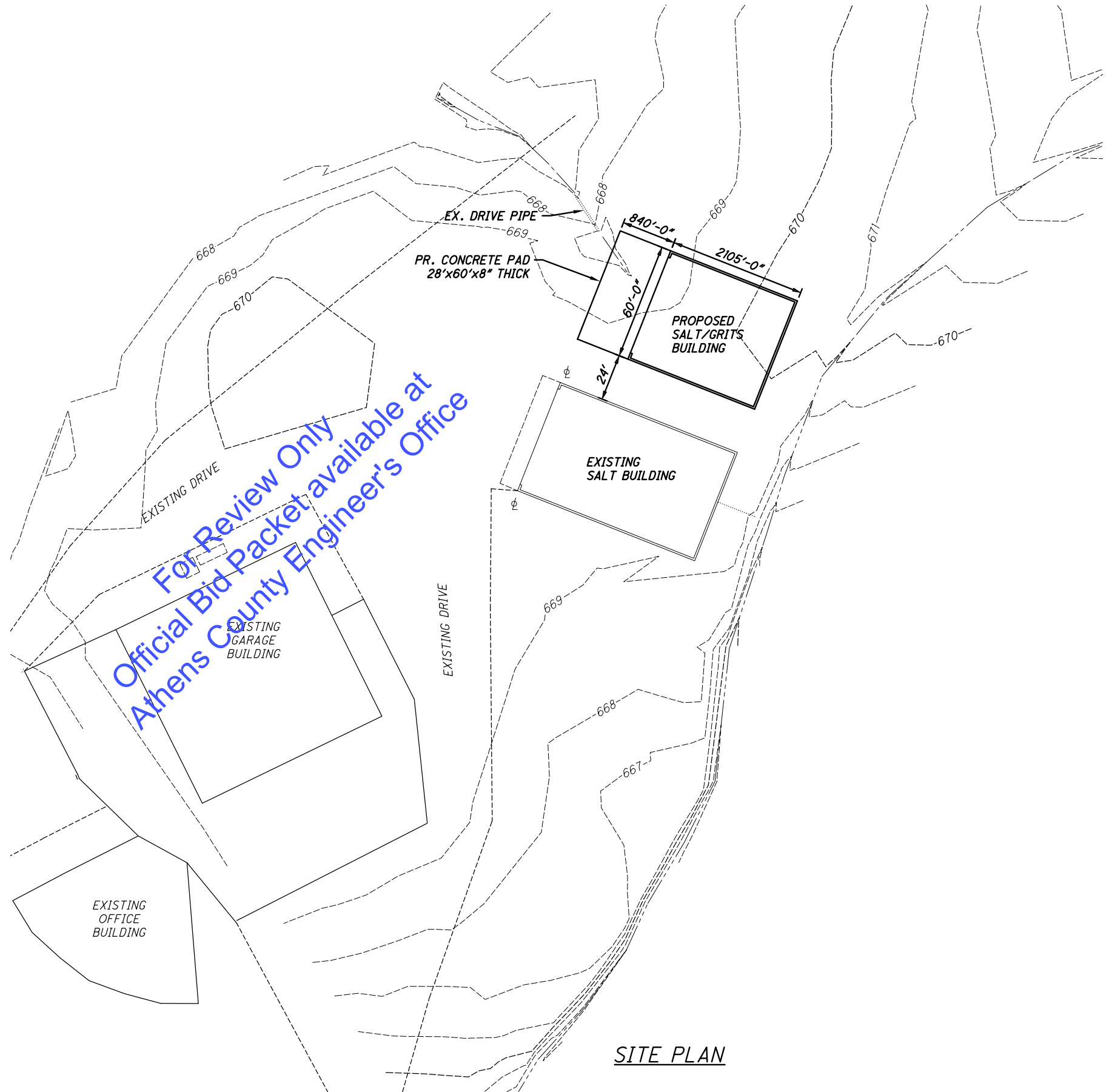
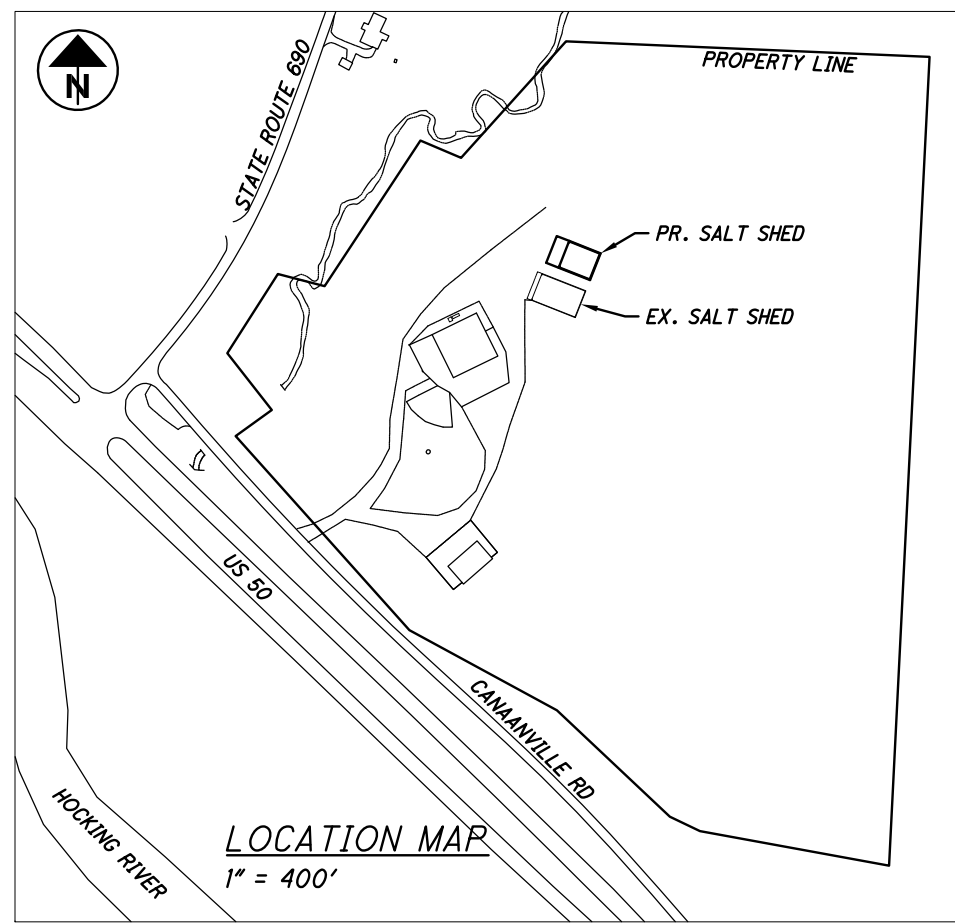

CALCULATED	
DES	
CHECKED	
RJM	

BUILDING SITE PLAN

SALT/GRIT STORAGE

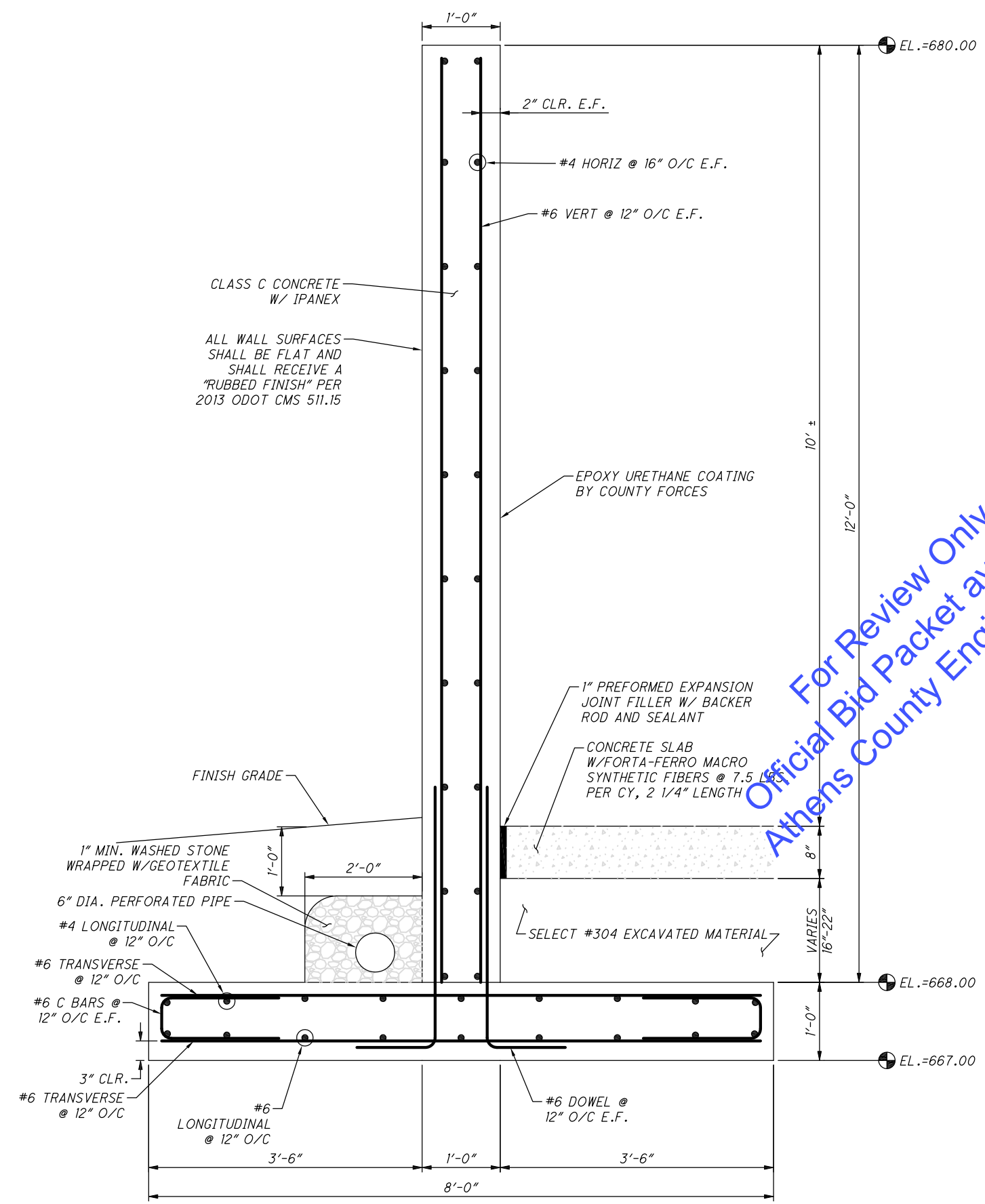

SECTION A-A
1" = 20'

FOUNDATION NOTES

1. MAX SOIL BEARING PRESSURE = 1,204 PSF. PLACE NO CONCRETE PRIOR TO INSPECTION AND APPROVAL OF BEARING SURFACES BY ENGINEER.
2. KEEP FOUNDATIONS FREE OF WATER AT ALL TIMES.
3. TOP OF CONCRETE SLAB ELEVATION AT FRONT OF BUILDING = 670.0 AND AT REAR OF BUILDING = 670.4.

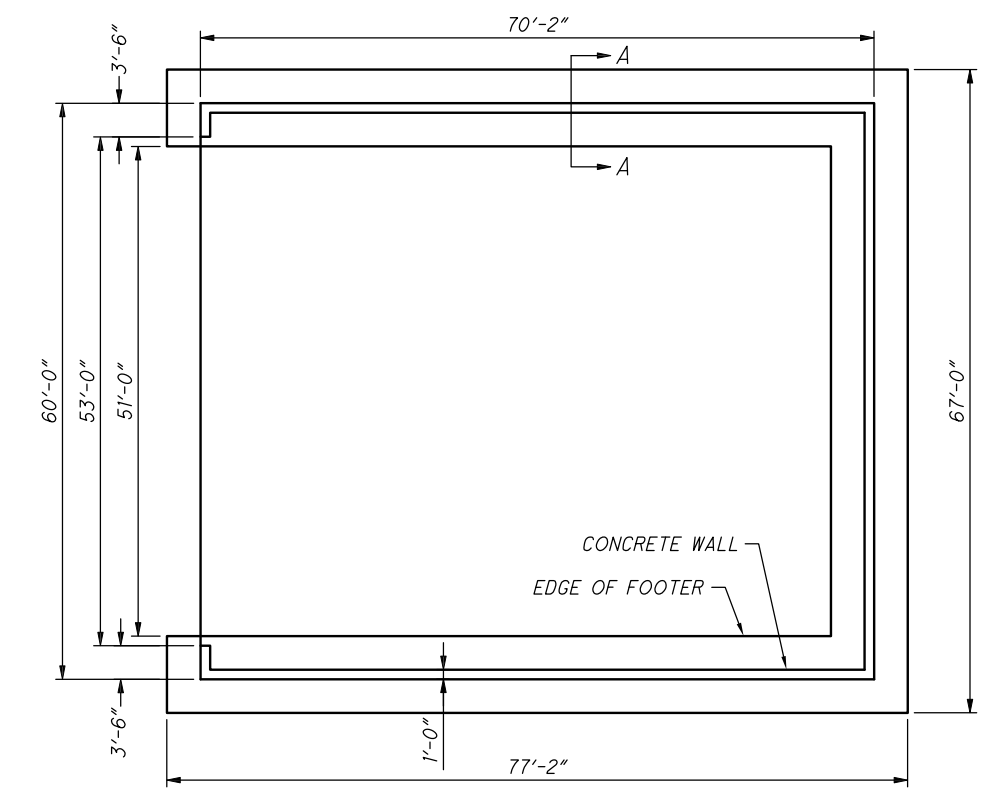

FOUNDATION PLAN
1" = 20'



For Review Only
Official Bid Packet available at
Athens County Engineer's Office

SPECIAL PROCEDURE SUBMITTAL

The project specifications include the use of a macro-synthetic fiber, FORT A-FERRO®. The Use of this product may influence your bid or placement practices. This document and resulting submittal below are to emphasize and call attention to this change from previous specifications.

Prior to your bid submittal review the following four categories:

1. Fiber Addition and Mixing

Failure to follow these procedures raises the risk of fiber "balling", and diminishes the degree of Uniform distribution.

- Do NOT front-load fiber before other ingredients have been added to the drum.
- Add the fibers with the drum turning after the other ingredients have been added.
- AFTER all the fibers have been added to the batch, mix for not less than five minutes as per ACI recommendations and at drum rated mixing speed.

2. Slump

Macro-synthetic fibers will reduce the visual slump of the concrete as measured by the Conventional slump-cone test. The actual concrete workability will be affected to a much lesser Degree. The fiber is NOT absorbing any water.

- Do NOT add water to achieve the desired slump.
- AFTER all fibers have been added to the batch, additional superplasticizer may be added per the project engineer's recommendations, to achieve the desired workability.

3. Pumping

Actual pumping of macro-synthetic fiber typically results in a more uniform pressure, and at less Pumping pressure than that of plain concrete. However, issues at the pump-hopper grate should Be addressed. The fiber manufacturer recommends using a "round-bar" grate, by replacing the Thin-slat tines with 2 inch to 3 inch diameter round-bar stock, maintaining a standard 2 1/2 inch Space opening.

If using a traditional pump-grate

- Raise the truck chute well above the grate.
- Do NOT allow build of concrete on the grate or in the hopper.
- Monitor the grate for any fiber buildup and push - move the fiber concrete through the grate manually.
- Expect longer discharge times when using a standard grate.

ALWAYS use a vibrator attached directly to the grate.

4. Finishing

Fibers will be distributed uniformly and three-dimensionally throughout the concrete, and as Such, will be at or near any exposed surface such as the top of a floor. The following techniques And practices with regards to finishing practices will help minimize the appearance of fibers on The surface. Macro-synthetic fibers in concrete typically slow or reduce water bleedings to the

Surface.

- Do NOT start finishing procedures too early.
- Use the ACI- recommended "footprint" indication for proper starting time.
- Use steel/magnesium tools and trowels.
- Use a stiff bristle concrete-broom for textured finishes.
 - i. Hold broom as close to the surface as possible (low angle).
 - ii. Pull in one direction only once.
 - iii. Do NOT overlap brush strokes.
- Tilt mechanical finish blades at a sufficient angle to depress coarse aggregates and Fibers into the surface paste fraction.
- Roller bug screeds or jitterbugs can be used to help bury the fibers in the surface paste Fraction.

For additional information and/or assistance related to the use of FORT A-FERRO® for this Project, please contact FORTA Corporation at #1-800-245-0306, or visit the website at www.fortacorp.com.

I have read and completed due diligence to understand the information above and included in the Specifications, and my enclosed bid submittal package considers the use of FORT A-FERRO® in This project.

By

Company

Title

Date

For Review Only
Official Bid Packet available at
Athens County Engineer's Office

**BID FORM
ATHENS COUNTY, OHIO**

SALT/GRIT STORAGE STRUCTURE

The undersigned, having full knowledge of the sites, plans, addenda and specifications for the following improvement and the conditions of this proposal, hereby agrees to furnish all services, labor, materials and equipment necessary to complete the entire project, according to the plans, specifications, addenda and completion date, and to accept the unit prices specified for each item as full compensation for the work in this proposal.

The "TOTAL AMOUNT OF LUMP SUM BID" = \$ _____

TOTAL AMOUNT IN WORDS

Bidder's Name: _____

Telephone: _____

E-mail: _____

Mailing Address: _____

Federal Tax I.D. Number _____

RECEIPT OF ADDENDA #'S _____, _____, _____

IS THIS BID FOR AN ALTERNATE DESIGN? _____

Yes or No

NOTE: CHECK YOUR BID FOR CORRECTNESS. ERRORS IN ADDITION AND/OR EXTENSION WILL BE CORRECTED BY THE ATHENS COUNTY ENGINEER PRIOR TO RECOMMENDATION OF AWARD. ERASURES, STRIKEOVER AND/OR WHITEOUT SHALL VOID THIS BID.

*** 100% BID GUARANTY BOND REQUIRED ***
(OR CERTIFIED OR CASHIER'S CHECK IN THE AMOUNT OF
10% OF THE BID)

NOTE: BIDDERS ARE TO RETURN ALL PAGES IN SECTION I WITH SATISFACTORY BOND.

PROPOSAL (BINDER)

(This page must be executed, in the appropriate place, prior to submission of this bid).

On acceptance of the proposal for said work _____ do
I or we

hereby bind _____ this ____ day of _____, 20____ to enter into a written
myself or ourselves

contract with the Athens County Commissioners within ten days from date of notice of award.

IF AN INDIVIDUAL, SIGN BELOW:

Name Post Office address

IF AN INDIVIDUAL DOING BUSINESS UNDER A TRADE NAME, SIGN BELOW:

Trade Name Post Office address

Sole Owner By

IF A PARTNERSHIP, SIGN BELOW:

Name of partnership Post office address

By: _____
Partner Post office address

Partner Post office address

IF A JOINT BID, SIGN BELOW:

Name Name

By: _____ By: _____

Post office address Post office address

IF A COPORATION, SIGN BELOW:

Name of corporation
Incorporated under the laws of the state of _____

By: _____
Signature Title of officer signing

CERTIFICATION AGAINST DEBARMENT AND SUSPENSION

The bidder hereby certifies, except as noted below, under penalty of perjury and under other such penalties as the laws of this state and the United States of America provide, that the company or any person associated therewith in the capacity of owner, partner, director, officer, principal investigator, project director, manager, auditor, or any position involving the administration of federal funds is **not** currently under suspension, debarment, voluntary exclusion or determination of ineligibility by any federal agency; that the company or any person associated therewith in the capacity of owner, partner, director, officer, principal investigator, project director, manager, auditor, or any position involving the administration of federal funds has **not** been suspended, debarred, voluntarily excluded or determined ineligible by any federal agency within the past three (3) years; that the company or any person associated therewith in the capacity of owner, partner, director, manager, auditor, or any position involving the administration of federal funds does **not** have a proposed debarment pending; that the company or any person associated therewith in the capacity of owner, partner, director, officer, principal investigator has **not** been indicted, convicted, or had a civil judgment rendered against the company, or themselves by a court of competent jurisdiction in any matter involving fraud or official misconduct within the past three (3) years.

If there are exceptions to any of the above clauses, please set out the exceptions on the lines below. Exceptions will not necessarily result in denial of award, but will be considered in determining bidder responsibility. For any exception noted, indicate below to whom it applies, initiating agency and dates of action. Providing false information may result in criminal prosecution or administrative sanctions.

Execution of this proposal on the signature portion thereof shall constitute also signature of this certification as permitted by Title 28 United State Code, Section 1746.

Official Bid Packet Available at
Athens County Engineers Office

BID AFFIDAVIT

(To be filled in and executed if Contractor is a Corporation)

STATE OF _____)

)ss

COUNTY OF _____)

_____ being duly sworn, deposes and says that he is Secretary of
_____ a corporation organized and existing under and by virtue of the laws of
the State of _____ and having its principal Office at

Number and Street

_____ County, _____ State
City Name of County State

Affiant further says that he is familiar with the records, minute books and by-laws of

Name of Corporation

Affiant further says that _____ of the
Name of Officer Title

corporation is duly authorized to sign the contract for _____ for

said corporation by virtue of _____

State whether a provision of by-laws or a resolution of the Board of Directors. If by a resolution, give date of adoption.

Signature of Officer

Sworn to before me and subscribed in my presence this _____ day of

_____, 20____.

Notary Public in and for

_____ County, Ohio

My Commission expires _____

NON-COLLUSION AFFIDAVIT

STATE OF _____)

)SS.

COUNTY OF _____)

_____, being first duly sworn,

deposes and says that he is _____
sole owner, partner, president, etc.

of _____ the party making the foregoing proposal or bid; that such bid is genuine and not collusive of sham; that said bidder has not colluded, conspired, connived, or agreed, directly or indirectly, with any bidder or person, to put in a sham bid, or that such other person shall refrain from bidding, and has not in any manner, directly or indirectly sought by agreement or collusion, or communication or conference, with any person, to fix the bid price of affiant or any other bidder, or to fix any overhead, profit, or cost element of said bid price, or of that of any other bidder, or to secure any advantage against _____ or any person or persons interested in the proposed contract; and that all statements contained in said proposal or bid are true, and further, that such bidder has not, directly or indirectly submitted this bid or the contents thereof, or divulged information or data relative thereto to any association or to any member or agent thereof.

Official Bid Packet Available at
Athens County Engineers Office

Affiant

Sworn to and subscribed before me this _____ day of _____, 20 _____.

Notary Public in and for _____ County, Ohio

My commission expires _____

NO FINDINGS FOR RECOVERY AFFIDAVIT

(O.R.C. Section 9.24)

THIS FORM MUST BE COMPLETED IN ITS ENTIRETY AND NOTARIZED

I _____,
(NAME) (TITLE) (NAME OF COMPANY)

affirm that at the time that I submitted the bid for _____
(BID TITLE)

to the Board of Athens County Commissioners on _____ that
(DATE)

_____ HAS / HAS NO unresolved finding for recovery from
(NAME OF COMPANY) (CIRCLE ONE)

the State Auditor per Ohio Revised Code 9.24.

(If there is a unresolved finding for recovery from the State Auditor, please complete the following section)

The amount of unresolved finding for recovery due the State Auditor is _____ and unpaid penalties and interest are _____.
(AMOUNT) (AMOUNT)

*For Review Only
Official Bid Packet available at
Athens County Engineer's Office*

(SIGNATURE)

(COMPANY)

(DATE)

Sworn to and subscribed before me this _____ day of, _____ 20____. (SEAL)

(NOTARY)

My Commission Expires:

(DATE)

BID GUARANTY AND CONTRACT BOND

KNOW ALL MEN BY THESE PRESENT, that we, the undersigned, _____

_____ as Principal and _____

as Surety, are hereby held and firmly bound unto _____

_____ hereinafter called the Obligee, in the penal sum of the dollar amount of the bid submitted by the Principal to the obligee on _____ to undertake the project known as:

_____ The penal sum referred to herein shall be the dollar amount of the Principal's bid to the Obligee, incorporating any additive or deductive alternate proposals made by the Principal on the date referred to above to the Obligee, which are accepted by the Obligee. In no case shall the penal sum exceed the amount of _____ DOLLARS (\$ _____).

If this item is left blank, the penal sum will be the full amount of the Principal's bid, including alternates. Alternatively, if completed, the amount stated must not be less than the full amount of the bid, including alternatives in dollars and cents. A percentage is not acceptable.

For the payment of the penal sum well and truly to be made, we hereby jointly and severally bind ourselves, our heirs, executors, administrators, successors, and assigns.

THE CONDITION OF THE ABOVE OBLIGATION IS SUCH, that whereas the above named Principal has submitted a bid on the above referred to project,

NOW, THEREFORE, if the obligee accepts the bid of the Principal and the Principal fails to enter into a proper contract in accordance with the bid, plans, details, specifications, and bills of material; and in the event the Principal pays to the Obligee the difference not to exceed ten percent of the penalty hereto between the amount specified in the bid and such larger amount for which the obligee may in good faith contract with the next lower bidder to perform the work covered by the bid; or in the event the Obligee does not award the contract to the next lower bidder and resubmits the project for bidding, the Principal will pay the Obligee the difference, not to exceed ten percent of the penalty hereof between the amount specified in the bid, or the costs, in connection with the resubmission, of printing new contract documents, required advertising and printing and mailing notices to prospective bidders, whichever is less, then this obligation

Here insert full name or legal title of Contractor and address

Here insert full name or legal title of Surety

Here insert full name or legal title of Owner

shall be null and void, otherwise to remain in full force and effect. If the obligee accepts the bid of the Principal and the Principal within ten days after the awarding of the contract, enters into a proper contract in accordance with the bid, plans, details, specifications, and bills of material, which said contract is made a part of this bond the same as though set forth herein; and

IF THE SAID Principal shall well and faithfully perform each and every condition of such contract; and indemnify the Obligee against all damage suffered by failure to perform such contract according to the provisions thereof and in accordance with the plans, details, specifications, and bills of materials therefore; and shall pay all lawful claims of subcontractors, materialmen, and laborers, for labor performed and materials furnished in the carrying forward, performing, or completing of said contract: we agreeing and assenting that this undertaking shall be for benefit of any materialman or laborer having a just claim, as well as for the Obligee herein; then this obligation shall be void; otherwise the same shall remain in full force and effect; it being expressly understood and agreed that the liability of the Surety for any and all claims hereunder shall in no event exceed the penal amount of this obligation as herein stated.

THE SAID Surety hereby stipulates and agrees that no modifications, omissions, or additions, in or to the terms of said contract or in or to the plans and specifications therefore shall in any way affect the obligations of said Surety on this bond, and it does hereby waive notice of any such modifications, omissions or additions to the terms of the contract or to the work or to the specifications.

SIGNED AND SEALED This ____ day of _____, 20__.

Principal

By: _____

Title: _____

Surety

By: _____

Attorney-in-Fact

Surety Company Address

Surety Agent's Name and Address

Official Bid Packet available at
Athens County Engineer's Office

Instructions for Completion of the Bid Guaranty & Contract Bond

The Bid Guaranty and Contract Bond, meeting the requirements of Section 153.54 (B) of the Ohio Revised Code, as furnished by Athens County, shall be used and submitted by the bidder without change of wording.

The amount of the Bid Guaranty and Contract Bond must be for the full amount of the bid.

The Bid Guaranty and Contract Bond must be signed by an Authorized Agent of an acceptable Surety Bonding Company, and by the Bidder. The Bid Guaranty and Contract Bond must be countersigned by a Resident Agent of the Bonding Company as required by Section 3905.41 of the Ohio Revised Code. The Corporate Seal is to be affixed to all copies. The name and address of both the Surety and the Surety's Agent must appear on the Guaranty form.

A power of attorney of the Agent shall be attached to and submitted with the Bid Guaranty and Contract Bond.

For Review Only
Official Bid Packet available at
Athens County Engineer's Office

CONTRACT

THIS AGREEMENT, made and entered into this _____ day of _____, 2017, by and between the Board of County Commissioners of Athens County, Ohio acting by and through Lenny Eliason, President, hereinafter designated the Owner, and _____ of the City of _____, County of _____ and State of _____, hereinafter designated the Contractor:

WITNESSETH: That the parties to these present, each in consideration of the undertakings, promises and agreements on the part of the other herein contained, have undertaken, promised and agreed and do hereby undertake, promise and agree, the owner for itself, its successors and assigns, and the contractor for itself and its heirs, executors, administrators, successors and assigns, as follows:

That the contractor, in consideration of the sums of money herein specified to be paid by said owner to said contractor, shall and will at its own cost and expense, furnish all labor, materials and equipment necessary to complete the entire SALT/GRIT STORAGE STRUCTURE PROJECT in accordance with the Proposal submitted on _____ and in accordance with the Specifications, General Provisions and Special Provisions and the Drawings therein mentioned which Specifications, General Provisions, Special Provisions and Drawings, together with Advertisement Information for Bidders, Proposal and Bonds are hereby made a part of this Agreement, and incorporated by reference herein, all of said work to be fully completed to the satisfaction of the Engineer and to the acceptance of the Board of County Commissioners, Athens County, Ohio.

Attest:

Contractor: _____

Board of Commissioners, Athens County, Ohio

Date

Lenny Eliason Date

Printed Name Title

Charlie Adkins Date

Witness

Chris Chmiel Date

CERTIFICATE OF PROSECUTING ATTORNEY

The above contract has been approved by me as to form this _____ day of _____, 2017.

Prosecuting Attorney, Athens County, Ohio

CERTIFICATE OF COUNTY AUDITOR

I, _____, County Auditor of Athens County,

Ohio do hereby certify that there is in the Treasury or in the process of collection, the sum of:

_____/100-----Dollars (\$ _____), to

pay for the contract between _____ and the Athens County Commissioners,

Athens County, Ohio and that said funds are un-appropriated for any other purpose.

Athens County Auditor

Purchase Order No. _____

Account No. _____

For Review Only
Official Bid Packet available at
Athens County Engineer's Office

CERTIFICATE OF BOARD OF COMMISSIONERS

We, the Board of Commissioners of Athens County, in formal session, hereby approve these plans and specifications and certify that the right of way necessary for this improvement is available and declare that the making of this improvement is necessary and in the public interest.

Board of County Commissioners

Date: _____

CERTIFICATE OF COUNTY ENGINEER

I hereby approve these plans and specifications and declare that the making of this improvement will not require the closing of traffic of the highway and that provisions for the maintenance and safety of traffic have been provided for.

Official Bid Packet available at
Athens County Engineer's Office

R. Jeff Maiden, P.E., P.S.
Athens County Engineer

SALT/GRIT STORAGE STRUCTURE PROJECT

ATHENS COUNTY, OHIO

SECTION II

Athens County General Conditions

*For Review Only
Official Bid Packet available at
Athens County Engineer's Office*

**SECTION II – ATHENS COUNTY
GENERAL CONDITIONS**

TABLE OF CONTENTS

SECTION – TOPIC	PAGE
1. DEFINITIONS	1
2. INTENT	1
3. CONTRACT DOCUMENTS	1
4. INTERPRETATION OF CONTRACT DOCUMENTS	2
5. FEDERAL-AID PROVISIONS	3
6. OBLIGATIONS OF THE CONTRACTOR	3
7. PERMITS, LAWS, AND REGULATIONS	3
8. STRUCTURES ENCOUNTERED AND PROTECTION OF PROPERTY	4
9. TIME OF ESSENCE	4
10. CONTRACT	4
11. EXAMINATION OF SITE	5
12. ESTIMATED QUANTITIES	5
13. PROGRESS SCHEDULE	5
14. CHANGE ORDERS	5
15. EXTRA WORK NOT CONTEMPLATED BY CONTRACT	6
16. SIGNIFICANT CHANGES IN THE CHARACTER OF WORK	6
17. COMPETENT MEN TO BE EMPLOYED	7
18. ANTI-DISCRIMINATION	7
19. FORFEITURE FOR PROHIBITED DISCRIMINATION	7
20. MINIMUM WAGE RATES	7
21. PAYROLL RECORDS	7
22. MATERIALS AND WORKMANSHIP	8
23. DEFECTIVE WORK AND MATERIALS	8
24. OWNERS RIGHT TO SUSPEND OR TERMINATE CONTRACT	8
25. FAILURE TO COMPLETE WORK ON TIME	9
26. EXTENSION OF TIME	9
27. WORK ON SUNDAYS AND HOLIDAYS	9
28. WORK TO BE SUBLET	9
29. TRAFFIC TO BE MAINTAINED	10
30. ENVIRONMENTAL PROTECTION	10
31. BARRICADES, LIGHTING AND WATCHMEN	11
32. ALTERNATE PLANS	12
33. REMOVED MATERIALS	12
34. PATENTS	12
35. PREVENTION OF, AND INDEMNIFICATION FOR, ACCIDENTS	12
36. INSURANCE AND WORKERS COMPENSATION	13
37. CLEAN UP	14
38. LUMP SUM PRICES	15
39. PARTIAL PAYMENTS	15
40. FINAL ESTIMATE	15
41. UNDERGROUND UTILITIES	15
42. ADDITIONAL SPECIFICATIONS INCORPORATED HEREIN BY PREFERENCE	15
43. GUARANTEE	15
44. RELEASE OF OWNER	16
45. UNBALANCED BIDDING	16
46. DISPUTES AND CLAIMS	16

1. DEFINITIONS

Whenever the words defined in this paragraph, or pronouns used in their stead, occur in this contract they shall have the meaning given:

- (a) County or Owner shall mean the County of Athens acting through its authorized representative, the Board of County Commissioners.
- (b) Contractor or bidder shall mean any person, firm or corporation entering into the Contract or Contracts covered under these specifications for the performance of the work required by it or agent appointed to act for said party in the performance of the work.
- (c) Engineer shall mean the duly elected, qualified and acting Engineer of Athens County, Ohio, or such assistants as he may appoint, authorize and assign to administer the contract.
- (d) Or Equal. Wherever a particular brand, make of material, device or equipment is specified, it is to be regarded as a standard. The contractor may proffer for acceptance other makes, brands, devices or equipment in place of those specified. If in the opinion and judgment of the Owner, the items offered and the work proposed is considered to be a satisfactory equal to that called for in the specifications, the Owner may approve of the use of the substitute offered, and it will be accepted for the work provided; further, that all materials, methods and workmanship shall be appropriate and in accordance with best modern practice as determined by Owner, who shall be the sole judge.
- (e) Wherever in the specifications or upon the drawings the word "direction, required, permitted, ordered, designated prescribed" or words of like import are used, it shall be understood that the direction, requirements, permission, order, designation, or prescription of the Owner is intended and similarly the words approved, acceptable, or satisfactory to the Owner unless otherwise expressly stated.

2. INTENT

It is the intent of these General Specifications to cover the governing conditions of work, labor, materials, detailed drawings, methods, measures, safety rules and factors applicable in whole or in part to this contract or contracts.

3. CONTRACT DOCUMENTS

The following shall constitute the Contract Documents and shall be deemed the Contract made pursuant to this invitation to bid:

- (a) The bid advertisement, Notice and Information to Bidder to bid, General Conditions, detail specifications, Drawings, and Special Provisions, as are included in the bid package.
- (b) Affidavit of non-collusion
- (c) The Bid or Proposal

- (d) All required bonds and certificates of insurance
- (e) All provisions required by law to be inserted in the contract, whether actually inserted or not
- (f) Contract
- (g) Affidavit for corporate bidders

4. INTERPRETATION OF CONTRACT DOCUMENTS

- a) If any person, firm or corporation contemplating submitting a bid for this Contract is in doubt as to the true meaning of any part of the Drawings, Specifications or other Contract Documents, he may submit to the County Engineer a written request for an interpretation thereof. The person, firm or corporation submitting the request shall be responsible for its prompt delivery. Any interpretation of the proposed documents will be made only by an Addendum duly issued by the Engineer and a copy of such Addendum will be mailed or delivered to each person securing a set of the Contract Documents, provided that a sufficient period of time is available for the issuance of such Addendum prior to the receipt of bids.
- b) The specifications are duplicates of those on file in the office of the County Commissioners and County Engineer
- c) Any doubts which may arise after letting the contract shall be referred to the Engineer and County who shall decide the question at issue, and their decision shall be final and binding upon the parties to the contract.
- d) The drawings and specifications are complementary and what is called for by either one shall be as binding as if called for by both.
- e) In unit price contracts the quantities listed in the Proposal are to be considered as approximate and are to be used for the comparison of bids only. The unit prices to be tendered by the Bidders are to be tendered expressly for the scheduled quantities as they may be increased or decreased as hereinafter provided. Payments, except for lump sum items in unit price contracts, will be made to the Contractor for the actual quantities only of work performed or materials furnished in accordance with the plans and specifications and it is understood that scheduled quantities for work to be done and materials to be furnished may each be increased or diminished as hereinafter provided without in any way invalidating the unit bid prices. Where there is a conflict between the unit bid price and the extension thereof made by the Bidder, the unit price shall govern and the County shall be authorized to make a correct extension in comparing bids.
- f) If the work is let on the basis of a lump sum contract, the estimated quantities are only approximate, although the result of calculations may be in error and the Bidder must obtain and be responsible for the data upon which he bases his bid. He shall not be entitled to any additional compensation in case the quantities of work actually done to fulfill the contract and complete the project are greater than said estimated quantities.

5. FEDERAL-AID PROVISIONS

When the United States Government pays for all or any portion of the Project's cost, the Work is subject to the inspection of the appropriate Federal agency.

Such inspections will not make the Federal Government a party to this Contract. The inspections will in no way interfere with the rights of either party to the Contract.

Federal Highway Language, requirements, and prohibitions overrides or trumps that of any other Federal or state agency (e.g. HUB, Public Works).

6. OBLIGATIONS OF THE CONTRACTOR

The Contractor shall do all work and shall furnish all the labor, materials, tools, appliances and equipment except as herein otherwise specified, necessary or proper for performing and completing the work required by this contract, in the manner and within the time hereinafter specified.

If, at any time before the commencement or during the progress of the work or any part of it, the Contractor's methods or appliances appear to the Engineer to be unsafe, insufficient or inadequate for securing the safety of the workmen, the quality of the work or the progress required, he may order the Contractor to increase their safety and efficiency or to improve their character, and the Contractor shall comply with such order, but the failure of the Engineer to make such demand shall not relieve the Contractor of his obligations to secure the safe conduct, the quality of the work and the progress required by the contract, and the Contractor alone shall be responsible for the safety, efficiency, and adequacy of his plant, appliances and methods.

All the work to be done and the labor and materials to be furnished under this contract shall be done and furnished strictly pursuant to and in conformity with the specifications and the drawings therein referred to under the direction of the Engineer as given by him from time to time during the progress of the work, and under the terms of this contract, and the Contractor shall complete the entire work to the satisfaction of the Owner and at the prices and time herein agreed upon and fixed therefore.

7. PERMITS, LAWS, AND REGULATIONS

The contractor shall comply with all applicable laws of the federal government, the State of Ohio, and Municipal Corporations pertaining to wages, public liability and property damage. Workmen's Compensation and insurance of employees, current wage scales, payment for material, subcontract relations, and any other local, state or federal laws or ordinances concerned with contracts of this nature. Ignorance of legislation as described will in no way excuse the Contractor from full compliance with all statutes and regulations. Attention is directed to Section 1311.28 thru 1311.33 Revised Code of Ohio, which provides for retention by the Owner of additional payments due the Contractor in the event the Contractor fails to pay legal labor, materials and equipment bills out of monies previously received from the Owner. Claims against the Contractor must be properly authenticated and supported by the claimant before the Owner can take action.

The Contractor shall keep himself fully informed of all Federal State and Municipal laws and ordinances and regulations in any manner affecting those engaged or employed in the work or the materials used in the work, or in any way affecting the conduct of the work, and of all orders and decrees of bodies or tribunals having any jurisdiction or authority over the same. If

any discrepancy or inconsistency should be discovered in this contract, or in the drawings or specifications herein referred to, in relation to any such law, ordinance, regulation, order or decree, he shall forthwith report the same in writing to the Engineer. He shall at all times himself observe and comply with, and shall cause all his agents and employees to observe and comply with all such existing and future laws, ordinances, regulations, orders, and decrees, and shall protect and indemnify the Owner and its officers and agents against any claim or liability arising from or based on the violation of any such law, ordinance, regulation, order or decree, whether by themselves or by their employees.

The contractor shall be responsible for securing at his own expense any and all licenses, permits and certificates of inspection required by law, or by the contract documents.

8. STRUCTURES ENCOUNTERED AND PROTECTION OF PROPERTY

- a) The contractor shall, at his own expense, support and protect all buildings, bridges, conduits, wires, water pipes, gas pipes, sewers, pavements, curbing, sidewalks, equipment and fixtures of all kinds and all other public or private property, whether of this or another contract that may be encountered or endangered in the prosecution of the work herein contemplated and that are not otherwise provided for. He shall repair and make good any damage caused to such property by reason of his operations, leaving all work in approved condition at the completion of the contract.

9. TIME OF ESSENCE

Since this contract is for a needed improvement, the provisions relating to the time of performance and time of completion of the work included in this contract are of the essence of this contract. The Contractor shall begin work promptly and complete the work by the day specified in the "Information for Bidders" and shall prosecute the work diligently so as to assure completion of the work not later than the time specified therefore.

10. CONTRACT

The bidder to whom the award is made will be required to execute a written Contract with the Owner, and to furnish and maintain good and approved surety bonds, as herein specified, within ten (10) days after notification of the acceptance of his bid. The Contract shall be in the form hereto attached. If the bidder to whom an award is made fails to enter into a contract as herein provided, the award may be annulled and the Contract let to the next lowest and best bidder in the opinion of the Owner; and such bidder shall fulfill every stipulation embraced herein, as if he were the original party to whom the award was made.

If the bidder to whom the award is made is a corporation, the Secretary of said corporation shall execute an affidavit, in the form hereto attached, stating that the officer or agent of said corporation signing the Contract for said corporation was authorized to do so, by either a provision of the corporation By-laws or by the adoption of a resolution of the Board of Directors of the corporation, whichever the case may be.

Contracts shall be let upon the basis of lump sum bids or upon the basis of unit price bids as set forth in the Proposal, at the discretion of the County.

The Engineer may cancel a Contract award at any time before all parties sign the Contract without liability to the Engineer.

11. EXAMINATION OF SITE

Prior to submitting a bid, bidders are required to satisfy themselves by personal examination at the site of the work and by an examination and study of the contract documents as to the conditions existing and the difficulties likely to be encountered in the construction of the work.

12. ESTIMATED QUANTITIES

The Contractor agrees that the estimated quantities are only for the purpose of comparing, on a uniform basis, the bids offered for the work under this Contract, and he further agrees that he is satisfied with and will at no time dispute the said estimated quantities as a means of comparing the bids aforesaid; that he will make no claim for anticipated profits or loss of profits because of a difference between the quantities of the various classes of work actually furnished and the said estimated quantities; and he agrees that the Owner shall not be held responsible if, in the construction of the work, any of the said estimated quantities should be found to vary from the quantities shown, or the Engineer without alteration or modification of this contract increases, decreases, or omits the amount of any class or portion of work as may be deemed necessary.

13. PROGRESS SCHEDULE

The Contractor shall furnish a bar chart progress schedule to the Engineer for review at or before the pre-construction conference. The Engineer will review the schedule and within 14 calendar days of receipt, will either accept the schedule or provide the Contractor with comments. Acceptance of the schedule does not revise the Contract Documents. Provide clarification or any needed additional information within 10 days of a written request by the Engineer. The County will withhold Estimates until the Engineer accepts the schedule. The Engineer will not measure or pay for the preparation of the schedule and schedule updates directly, but the cost of preparing and updating the schedule is incidental to all Contract Items.

Provide a working day schedule that shows the various activities of Work in sufficient detail to demonstrate a reasonable and workable plan to complete the Project by the Completion Date. Show the order and the sequence for accomplishing the Work. Describe all activities in sufficient detail so that the Engineer can readily identify the Work and measure the progress of each activity. The bar chart schedule must reflect the scope of work, required phasing, maintenance of traffic requirements, interim completion dates, the Completion Date, and other project milestones established in the Contract Documents. Include activities for submittals, working and shop drawing preparation, submittal review time for the County, material procurement and fabrication, and the delivery of materials, plant, and equipment, and other similar activities. The schedule must be detailed on letter or legal sized paper.

14. CHANGE ORDERS

- a) The County may, by written instructions to the Contractor, make alterations in the plans involving increases or decreases in the quantities of work as may be necessary or desirable, in either unit price or lump sum contracts. Such

alterations shall not be considered as a waiver to any of the conditions of the contract, nor invalidate any of the provisions thereof.

- b) The cost of increases or decreases in quantities of items shall be computed at the unit price bid and shall be added or deducted from the original contract, only upon written change order by the County.
- c) In the event the desired alterations in the plans or specifications involve items for which a unit price has not been established, the County shall request the Contractor to furnish a proposal for such items. If said proposal is acceptable, the County shall issue a written change order covering same. In the event that no agreement as to price can be arranged between the parties to the contract, the County shall determine and set up a fair price for the work and materials at issue and their decision shall be final and binding upon all parties concerned. No claims shall be made for extra work, unless the same shall have been done in pursuance of a written change order by the County and at a price previously agreed upon and approved by the County Commissioners.

15. EXTRA WORK NOT CONTEMPLATED BY CONTRACT

Wherever extra work due to unforeseen condition not contemplated by Contract becomes necessary for the construction of the project, a change order in writing for such extra work shall be first entered into before such work is performed. Such extra work shall be performed in accordance with the contract prices and if the items herein do not cover such work, a price mutually agreed upon shall prevail.

16. SIGNIFICANT CHANGES IN THE CHARACTER OF WORK

- a) The Engineer reserves the right to make, in writing, at any time during the work, such changes in quantities and such alterations in the work as are necessary to satisfactorily complete the project. Such changes in quantities and alterations shall not invalidate the contract nor release the surety, and the contractor agrees to perform the work as altered.
- b) If the alterations or changes in quantities significantly change the character of the work under the contract, whether such alterations or changes are in themselves significant changes to the character of the work or by affecting other work cause such other work to become significantly different in character, an adjustment, excluding anticipated profit, will be made to the contract. The basis for the adjustment shall be agreed upon prior to the performance of the work. If a basis cannot be agreed upon, then an adjustment will be made either for or against the contractor in such amount as the Engineer may determine to be fair and equitable.
- c) If the alterations or changes in quantities do not significantly change the character of the work to be performed under the contract, the altered work will be paid for as provided elsewhere in the contract.
- d) The term "significant change" shall be construed to apply only to the following circumstances:
 - 1. When the character of the work as altered differs materially in kind or nature from that involved or included in the original proposed construction; or
 - 2. When a major item of work, as defined elsewhere in the contract, is increased in excess of 125 percent or decreased below 75 percent of the original contract

quantity. Any allowance for an increase in quantity shall apply only to that portion in excess of 125 percent of original contract item quantity, or in case of a decrease below 75 percent, to the actual amount of work performed.

17. COMPETENT MEN TO BE EMPLOYED

The Contractor shall employ competent, skillful men to do The Work, and whenever the Engineer shall notify the Contractor in writing, that any man on The Work, is in his opinion, incompetent, unfaithful, disorderly, or otherwise unsatisfactory, or refuses to carry out the provisions of this contract, or to stop doing bad work when so ordered, or uses threatening or abusive language to any official having supervision of the work, such man shall be discharged from the work, and shall not again be employed on it, except with the written consent of the Engineer.

18. ANTI-DISCRIMINATION [R.C. 153.59]

The Contractor hereby agrees that in the hiring of employees for the performance of work under this contract or any subcontract, the Contractor, nor any subcontractor, nor any person acting on his behalf, shall by reason of race, creed, sex, disability, as defined in Section 4112.01 of the Revised Code, or color, discriminate against any citizen of the state in the employment of labor or workers who are qualified and available to perform the work to which the employment relates.

The Contractor also agrees that the Contractor, nor any subcontractor, nor any person on his behalf shall, in any manner, discriminate against or intimidate any employee hired for the performance of work under this contract on account of race, creed, sex, disability, as defined in Section 411.01 of the Revised Code, or color.

19. FORFEITURE FOR PROHIBITED DISCRIMINATION [R.C. 153.60]

If the Contractor breaches any of the above provisions against discrimination, there shall be deducted from the amount payable to the Contractor under this contract, a forfeiture of twenty-five dollars for each person who is discriminated against or in violation of this contract. If there is a second violation of breach of the provisions against discrimination, the contract shall be cancelled or terminated by the County and all of the money due for such subsequent violations of this discrimination clause may be forfeited.

20. MINIMUM WAGE RATES

The minimum wage to be paid to all skilled labor, intermediate grade labor, and unskilled and common labor employed on this contract shall be in accordance with the schedule of the "Davis-Bacon Wage Decision" as ascertained and determined by the US Housing and Urban Development Department, Office of Labor Relations as applicable.

21. PAYROLL RECORDS

Keep payroll records as specified in ORC 4115.07 or as required by Federal law. Authorized representatives of the Engineer may inspect the certified payroll and other payroll records. Upon completion of the Work and before receiving the final estimate and when required

by ORC 4115.07, submit an affidavit stating that wages have been paid according to the minimum rates specified in the Contract Documents.

22. MATERIALS AND WORKMANSHIP

The materials shall be of the best quality and especially adapted to the service required, and wherever the characteristics of any materials are not particularly specified, such material shall be used as is customary in first class work of a nature for which the material is employed. All materials shall, if required, be tested and shall fulfill the requirements specified. The Owner shall make physical test, but the Contractor shall furnish test pieces and samples, in the number, shape, size, and finish and required by the Engineer. The failure of test specimens to fully conform to the requirements of the specifications shall be sufficient cause for the rejection of the whole melt, pour, or stock from which the samples were obtained. The workmanship shall be of the highest class throughout.

23. DEFECTIVE WORK AND MATERIALS

The inspection of the work shall not relieve the Contractor of any of his obligations to fulfill his contract as herein prescribed, and defective work shall be made good and unsuitable material shall be rejected, notwithstanding that such work and materials have been previously overlooked by the Engineer and accepted or estimated for payment. If the work, or any part thereof, shall be found defective before the final acceptance of the whole work, the Contractor shall forthwith make good such defects without compensation, in a manner satisfactory to the Engineer, and if any of the material brought upon the ground for use in the work, or selected for the same, shall be condemned by the Engineer as unsuitable or not in conformity with the specifications; the Contractor shall forthwith discard such materials and remove them to a satisfactory distance from the vicinity of the work, and shall not again submit the same. If the Contractor shall fail to replace any defective work or materials after reasonable notice, the Engineer may cause such defective work or materials to be replaced and the expense thereof shall be deducted from the amount to be paid to the Contractor.

24. OWNERS RIGHT TO SUSPEND OR TERMINATE CONTRACT

- a) The Engineer may cause the work to be suspended whenever in his opinion the weather is not suitable for doing the work or for any other just or reasonable cause. Upon any suspension of the work, the Contractor shall snugly pile all material and he shall immediately thereafter remove all rubbish and surplus material from the place of work. In case of such suspension, the time within which the Contractor shall finish the work may be extended by as many days as he may have thus been delayed.
- b) If the Contractor shall at any time abandon the work, or if at any time the Engineer shall be of the opinion, and shall so certify to the Contractor and the County, that the work or any portion of it is unnecessarily delayed, or that the Contractor is willingly or knowingly violating any portion of his contract or executing it in bad faith, as far as claims of the Contractors are concerned, and the materials delivered at the site, and/or incorporated into the work shall become the property of Athens County.

25. FAILURE TO COMPLETE WORK ON TIME

If the Contractor fails to complete the work within the time allowed by the Contract, or extension thereof, the County Engineer shall keep accurate account of all expenditures for inspection, supervision, and all other similar engineering services in connection with the improvement and same shall be charged to the contractor. The amount of such expenditures shall be retained out of any estimates due or to become due to such Contractor.

26. EXTENSION OF TIME

If the Contractor is obstructed or delayed in the prosecution or completion of the work by neglect, delay, or default of any other contractor for adjoining contiguous work, or by any damage that may happen thereto by the unusual action of the elements, or by the abandonment of the work by the employees in general strike, or by any delay on the part of the Owner in doing the work, or furnishing the material to be done and furnished by it, the Contractor shall have no claim for damage for any such cause or delay, but, he shall in such case be entitled to such extension of time specified herein for the completion of work as the Engineer shall, in writing, certify to be just and proper, provided, however; that claim for such extension of time is made by the Contractor, in writing, within one (1) week from the time when such alleged cause for delay shall occur.

When a delay occurs due to unforeseen causes beyond the control and without fault, or negligence of the Contractor, including but not restricted to: acts of God, acts of the public enemy, acts of Government, acts of the State, or any political subdivision thereof; fires, floods, epidemics, strikes except those caused by improper act or omissions of the Contractor, extraordinary delays in delivery of materials caused by strikes, lockouts, wrecks, freight embargoes, (acts of governments), or acts of God, the time of completion shall be extended in whatever amount is determined by the County to be equitable.

An act of God is construed to mean an earthquake, flood, cloudburst, cyclone, or other cataclysmic phenomenon of nature beyond the power of the Contractor to foresee or to make preparation in defense of: A rain, windstorm, or other natural phenomenon of normal intensity, based on U.S. Weather Bureau reports for the particular locality and for the particular season of the year in which The Work is being prosecuted shall not be construed as an "act of God", and no extension of time will be granted for the delay's resulting there from.

27. WORK ON SUNDAYS AND HOLIDAYS

No Work shall be permitted on Sundays or legal Holidays except to save property or life, or in case of extraordinary emergency and then only as authorized or directed by the Engineer.

28. WORK TO BE SUBLET

In the event that the Contractor elects to sublet a part, or a portion of this contract, he shall first give written notice to the Owner. No part of the Contract shall be sublet without the written approval of the Owner.

Make payment to each subcontractor and supplier within 10 Calendar Days after receipt of payment from the County for Work performed or materials delivered or incorporated into the Project, according to ORC 4113.61, provided that the pay estimate prepared by the Engineer includes Work performed or materials delivered or incorporated into the public improvement by the subcontractor or supplier.

Also require that this contractual obligation be placed in all subcontractor and supplier contracts that it enters into and further require that all subcontractor and suppliers place the same payment obligation in each of their lower tier contracts. If the Contractor, subcontractors, or supplier subject to this provision fail to comply with the 10 Calendar Day requirement, the offending party shall pay, in addition to the payment due, interest in the amount of 18 percent per annum of the payment due, beginning on the eleventh Calendar Day following the receipt of payment from the County and ending on the date of full payment of the payment due plus interest.

Repeated failures to pay subcontractors and suppliers timely pursuant to this subsection will result in a finding by the County that the Contractor is in breach of Contract and subject to all legal consequences that such a finding entails. Further, repeated failures to pay timely pursuant to this subsection will result in a lower evaluation score for the Contractor and those subcontractors who are subject to evaluation by the County.

29. TRAFFIC TO BE MAINTAINED

Unless authorized by the Contract Documents for the Specific Contract, the Contractor shall not close to traffic any bridge, or culvert, or any portion of the highway during the progress of the work. To facilitate the maintaining of traffic, temporary site detours, bypasses, bridges, or culverts may be constructed when provided for by the Contract or authorized by the Engineer. The Engineer must approve any such construction before being put into service. The Contractor shall maintain such temporary construction in the manner necessary to facilitate safe and expeditious flow of traffic, and the Engineer shall be the final judge as to whether or not such temporary construction meets these conditions.

30. ENVIRONMENTAL PROTECTION

Comply with all Federal, State, and local laws and regulations controlling pollution of the environment. Avoid polluting streams, lakes, ponds, and reservoirs with fuels, oils, bitumens, chemicals, sediments, or other harmful materials, and avoid polluting the atmosphere with particulate and gaseous matter.

Fording of streams is prohibited. Causeways for stream and river crossings or for Work below a bridge are permitted provided:

- a) The causeway is constructed according to 207.03.B.8.b.
- b) The causeway complies with the requirements of the 404 Permit the Department obtained for the Project.
- c) The Contractor obtains a 404 Permit from the U.S. Army Corps of Engineers if the Department has not obtained such a permit. Obtain the 404 Permit prior to beginning construction of the causeway. The Department does not guarantee that the Contractor will be able to obtain a 404 Permit.

Comply with all current provisions of the Ohio Water Pollution Control Act, (OWPCA), (ORC Chapter 6111). The County will obtain a storm water permit under the OWPCA provisions when the plan work acreage requires a permit. The storm water permit will not cover the Contractor's work outside the Project limits shown on the Plans. Apply for a permit to cover operations outside the Project limits shown on the plans as required by the OWPCA provisions.

When the County has not applied for a permit on the Project and a permit is required under the provisions of the OWPCA because of the total area of the Contractor's work, apply for, obtain, and comply with the required permit for both the Work within Project limits and the Contractor's work.

The County has obtained the required permits from the U.S. Army Corps of Engineers and Ohio EPA for Work in the "Waters of the United States" and isolated wetlands under ORC Chapter 6111. Comply with the requirements of these permits.

When equipment is working next to a stream, lake, pond, or reservoir, spill response equipment is required in the event of a hydraulic leak. Do not stockpile fine material next to a stream, lake, pond, or reservoir.

Take precautions to avoid demolition debris and discharges associated with the excavation and hauling of material from entering the stream. Remove any material that does fall into the stream as soon as possible.

When excavating in or adjacent to streams, separate such areas from the main stream by a dike or barrier to keep sediment from entering the stream. Take care during the construction and removal of such barriers to minimize sediment entering the stream.

Accomplish control of ground water and water in excavations in a manner that prevents the degradation of the water quality of any surface water. Install wells and well points with suitable screens and filters where necessary to prevent the continuous pumping of fines. Pump sediment-laden water in a manner to prevent degradation of streams, lakes, ponds, or other areas of water impoundment. Such prevention may involve but is not limited to the means and methods described in Item 207. Use the current version of the *Sediment and Erosion Control Handbook* to plan this work. Use the methods necessary to prevent adverse effects to surface waters as provided in OAC-3745-1-04. The cost of constructing and maintaining these measures is incidental to the Contract.

Contain, collect, characterize and legally dispose of all waste water and sludge generated during the work. Do not mix waste water with storm water. Do not discharge any waste water without the appropriate regulatory permits. Manage waste water and sludge in accordance with ORC Chapter 6111 and all other laws, regulations, permits and local ordinances relating to this waste. Waste water management is incidental to the Work unless otherwise specified in the contract.

Control the fugitive dust generated by the Work according to OAC-3745-17-07(B), OAC-3745-17-08, OAC-3745-15-07, and OAC-3745-17-03 and local ordinances and regulations. In addition, use dust control measures when fugitive dust creates unsafe conditions as determined by the Engineer. Perform this work without additional compensation except for Item 616.

Perform open burning according to 105.16.

31. BARRICADES, LIGHTING AND WATCHMEN

The Contractor at his own expense shall place proper Barricades and other proper Traffic Control Devices along and around all construction where hazards and danger to traffic exists, and shall take such other precautions as are necessary to protect life and property, and shall place and maintain sufficient Lights at night for protection of the public. Watchmen shall be provided where safety requirements indicate.

32. ALTERNATE PLANS

In the event the County Commissioners elect to advertise for and receive Alternate Plans for the construction or erection of a bridge or structure, the bidder may at his option submit an alternate plan or plans for a different type of structure, or structures than that submitted by the County Engineer. Such plan or plans together with specifications shall be filed in the office of the County Engineer for a period of fifteen (15) days, prior to the date for receiving bids. Such plans and specifications shall show the number of spans, the length of each, the nature, quantity, quality, and size of materials to be used, the length of the structure when completed, and whether there is any patent on the proposed plan, or any part thereof, and if so, on what part thereof.

33. REMOVED MATERIALS

Unless otherwise provided for in the Contract, all existing road or bridge materials taken from the work shall be the property of Athens County. These materials shall be placed by the Contractor at his expense, at or on an area along the side of the road designated by the Engineer, for removal by the County.

34. PATENTS

The Contractor shall indemnify, keep and save harmless the Owner from all liabilities, judgments, costs, damages, and expenses which may in any wise come against the Owner by devices, equipment, or processes furnished, or used in the performance of the work under this Contract, by reason of the use of Patented designs furnished by the Contractor and accepted by the Owner.

In the event that any claim, suit or action at law, or in equity of any kind whatsoever, is made or brought against the Owner involving any such Patents, then the Owner shall have the right to retain from the money due and to become due the Contractor, a sufficient amount of money as shall be considered necessary by the Owner, to protect itself against loss until such claim, suit, or action shall have been settled and evidence to that effect shall have been furnished to the satisfaction of the Owner.

35. PREVENTION OF, AND INDEMNIFICATION FOR, ACCIDENTS

The Contractor, during the performance of the work, shall take all necessary precautions and place proper guards, or signs for the prevention of accidents, and shall put up and keep suitable and sufficient lights and other signals; and shall Indemnify and save harmless the County and its officers, agents and employees from all damages and costs, to which they may be put by reason of injury to person or property of another resulting from his negligence, or carelessness in the performances of the work, or in guarding the same, or from any improper materials, implements, or appliances used in its construction, or by, or on account of any act, or omission of the Contractor or his agents. The whole or so much of the moneys due under and by virtue of this Contract as shall be considered necessary by the Owner may, at his option, be retained by the Owner until all suits, or claims for damages as, aforesaid, shall have been settled, and evidences to that effect furnished to the satisfaction of the Owner.

36. INSURANCE AND WORKERS' COMPENSATION

Contractor shall indemnify and save harmless the State and all of its representatives, municipalities, counties, public utilities, any affected railroad or railway company, and any fee owner from whom a temporary Right-of-Way was acquired for the Project from all suits, actions, claims, damages, or costs of any character brought on account of any injuries or damages sustained by any person or property on account of any negligent act or omission by the Contractor or its subcontractors or agents in the prosecution or safeguarding of the Work. The Contractor shall procure and maintain insurance for liability for damages imposed by law and assumed under this Contract, of the kinds and in the amounts hereinafter provided from insurance companies authorized to do business in the State by the Ohio Department of Insurance. The cost of insurance is incidental to all contract items. Before the execution of the Contract by the Engineer, furnish to the County a certificate or certificates of insurance in the form satisfactory to the Department demonstrating compliance with this subsection. Provide an insurance certificate or certificates that show that the Contractor's liability and auto policies coverage are not reduced, restricted, or canceled until 30 days written notice has been given to the Department by the insurer.

Mail all certificates and notices to: Athens County Engineer, 16000 Canaanville Rd, Athens Ohio, 45701. Upon request, the Contractor shall furnish the County with a certified copy of each policy, including the provisions establishing premiums.

The types and minimum limits of insurance are as follows:

A. Workers' Compensation Insurance. Comply with all provisions of the laws and rules of the Ohio Bureau of Workers' Compensation covering all operations under Contract with the Department whether performed by it or its subcontractors. In addition, if a portion of the Work is performed from a barge or ship or requires unloading material from a barge or ship on a navigable waterway of the United States, it is the responsibility of the Contractor to arrange coverage for that portion of the Work under the Longshore and Harborworkers' Compensation Act [33 USC Section 901 *et seq.*] and the Jones Act [5 USC Section 751 *et seq.*] and provide proof of coverage to the Department.

B. Commercial General Liability Insurance. The minimum limits for liability insurance are as follows:

General Aggregate Limit - \$2,000,000
Products - Completed Operations
Aggregate Limit \$2,000,000
Personal and Advertising Injury Limit \$1,000,000
Each Occurrence Limit \$1,000,000

Obtain the above minimum coverages through primary insurance or any combination of primary and umbrella insurance. In addition, the Department will require the General Aggregate Limit on a per project basis. Ensure that the Commercial General Liability Insurance policy names the County of Athens, Engineer, its officers, agents, and employees as additional insureds with all rights to due notices in the manner set out above. Obtain Explosion, Collapse, and Underground (XCU) coverage at the same limits as the commercial general liability insurance policy. In addition, if blasting is to be performed, obtain XCU coverage providing a minimum

Aggregate Limit of \$5,000,000 and Each Occurrence Limit of \$1,000,000. Submit proof of insurance, endorsements, and attachments to the Engineer prior to starting the Work.

C. Comprehensive Automobile Liability Insurance. The Comprehensive Automobile Liability policy shall cover owned, non-owned, and hired vehicles with minimum limits as follows:

Bodily Injury and Property Damage Liability Limit
Each Occurrence \$1,000,000

Insurance coverage in the minimum amounts set forth neither relieves the Contractor from liability in excess of such coverage, nor precludes the County from taking such other actions as are available to it under any other provisions of this Contract or otherwise in law.

Clearly set forth all exclusions and deductible clauses in all proof of insurance submitted to the County. The Contractor is responsible for the deductible limit of the policy and all exclusions consistent with the risks it assumes under this Contract and as imposed by law.

If the Contractor provides evidence of insurance in the form of certificates of insurance, valid for a period of time less than the period during which the Contractor is required by terms of this Contract, then the County will accept the certificates but the Contractor is obligated to renew its insurance policies as necessary. Provide new certificates of insurance from time to time, so that the County is continuously in possession of evidence that the Contractor's insurance is according to the foregoing provisions.

If the Contractor fails or refuses to renew its insurance policies or the policies are canceled or terminated, or if aggregate limits have been impaired by claims so that the amount available is under the minimum aggregate required, or modified so that the insurance does not meet the requirements of 107.12.C, the County may refuse to make payment of any further monies due under this Contract or refuse to make payment of monies due or coming due under other contracts between the Contractor and the County. The County in its sole discretion may use monies retained pursuant to this subsection to renew or increase the Contractor's insurance as necessary for the periods and amounts referred to above. Alternatively, should the Contractor fail to comply with these requirements, the County may default the Contractor and call upon the Contractor's Surety to remedy any deficiencies. During any period when the required insurance is not in effect, the Engineer may suspend performance of the Contract. If the Contract is so suspended, the Contractor is not entitled to additional compensation or an extension of time on account thereof.

Nothing in the Contract Documents and insurance requirements is intended to create in the public or any member thereof a third party beneficiary hereunder, nor is any term and condition or other provision of the Contract intended to establish a standard of care owed to the public or any member thereof.

37. CLEANING UP

Upon completion of the work all surfaces disturbed during the work shall be restored in a satisfactory manner, and all tools, plant and equipment, and other property belonging to the Contractor, shall be removed and the site of the work left clear, and in a condition equal to that existing prior to the beginning of work under the Contract.

38. LUMP SUM PRICES

Where work is to be paid for by the Lump Sum, it is hereby, expressly agreed that in said Lump Sum shall be included all materials, labor, tools, and equipment required to fully complete the work, notwithstanding, that while the work may be fully shown on the Drawings, it may be partially described in other parts of the Contract Documents and vice versa.

39. PARTIAL PAYMENTS

The Contractor will be paid in accordance with Ohio Revised Code Sections 153.12, 153.13, and 153.14

40. FINAL ESTIMATE

The Engineer shall, as soon as practicable after the final acceptance of the work done under this Contract, make a Final Estimate of the amount of the work done, and the value thereof. Such Final Estimate shall be approved by the Owner, after which, the Owner, shall pay the sum so found to be due hereunder, after deducting there from, all previous payments, and all amount to be withheld under the Contract. All prior partial Estimates may be subjected to correction in the Final Estimate and payment.

41. UNDERGROUND UTILITIES

If the construction area may involve underground utility facilities, the Contractor, at least two working days prior to commencing construction operations in the construction area, shall cause notice to be given to the registered underground utility protection services and the owners of any underground utility facilities shown on the plans. The notice shall be in writing, by telephone, or in person. If the contractor gives written notice, it shall be by certified mail, return receipt requested. Identity and Location of Utilities are specified in the plans.

42. ADDITIONAL SPECIFICATIONS INCORPORATED HEREIN BY REFERENCE

Construction and Materials Specifications as set forth in the latest issue of the "State of Ohio, Department of Transportation, Construction and Materials Specifications" (ODOT CMS) and all supplemental specifications thereto, not otherwise provided for in these General Specifications, are incorporated herein by reference, and made a part of these General Specifications. Where a conflict exists between these specifications and the ODOT CMS, these specifications and the project plans shall govern.

The terms "engineer" or "county" shall be substituted as appropriate where the ODOT CMS refers to the "department".

43. GUARANTEE

The Contractor shall guaranty that all materials and equipment furnished and work performed under this contract are free from all defects for a period of one (1) year from the date of final payment. The provisions of Paragraphs 18 and 19 shall apply to any defect in the work, materials, apparatus or workmanship of the project or failure in the operation or performance of any part thereof or guarantees required hereunder determined by the Engineer to have occurred,

developed or appeared during the guaranty period. Ten percent (10%) of the Performance Bond shall remain in full force and effect through the guaranty period and until all defects detected during the guaranty period have been corrected to the satisfaction of the Owner. The Owner shall evidence release of the Performance Bond in writing and the Bond shall be in effect until said release has been obtained from the Owner.

The Contractor shall be required to show proof of insurance coverage meeting the requirements of Paragraph 31 prior to performing any work on the project during the guaranty period.

44. RELEASE OF OWNER

The end of the guaranty period shall be and shall operate as a release by the Contractor of all claims against and all liability of the Owner by reason of this Contract, and all things done or performed by the Contractor there under.

45. UNBALANCED BIDDING

Bid all items correctly and price each quantity as indicated in the Bid Documents. The County will reject a mathematically unbalanced bid if the bid is also materially unbalanced. A mathematically unbalanced bid is one that contains lump sum or unit price items that do not include reasonable labor, equipment, and material costs plus a reasonable proportionate share of the bidder's overhead costs, other indirect costs, and anticipated profit. A bid is materially unbalanced when the County determines that an award to the bidder submitting a mathematically unbalanced bid will not result in the lowest ultimate cost to the County.

46. DISPUTES AND CLAIMS

When a contractor (sub-contractors must pursue dispute through the contractor) feels there is additional work beyond the scope of the project due to changing site conditions or other unforeseen cause, he shall address his concern to the on site project representative who will contact the project engineer for on site dispute resolution. If an on site resolution cannot be reached, the contractor shall submit the issue in writing to the County Engineer who will investigate and meet with the contractor to try to resolve the issue. The Engineer will notify the contractor in writing of his decision and the contractor may accept the decision or he may file a claim with the appropriate Court.

SALT/GRIT STORAGE STRUCTURE PROJECT

ATHENS COUNTY, OHIO

SECTION III

State of Ohio Wage Rates

*For Review Only
Official Bid Packet available at
Athens County Engineer's Office*

Prevailing Wage Determination Cover Letter

County: ATHENS
 Determination Date: 07/27/2017
 Expiration Date: 10/27/2017

THE FOLLOWING PAGES ARE PREVAILING RATES OF WAGES ON PUBLIC IMPROVEMENTS FAIRLY ESTIMATED TO BE MORE THAN THE AMOUNT IN O.R.C. SEC. 4115.03 (b) (1) or (2), AS APPLICABLE.

Section 4115.05 provides, in part: "Where contracts are not awarded or construction undertaken within ninety days from the date of the establishment of the prevailing wages, there shall be a redetermination of the prevailing rate of wages before the contract is awarded." The expiration date of this wage schedule is listed above for your convenience only. This wage determination is not intended as a blanket determination to be used for all projects during this period without prior approval of this Department.

Section 4115.04, Ohio Revised Code provides, in part: "Such schedule of wages shall be attached to and made a part of the specifications for the work, and shall be printed on the bidding blanks where the work is done by contract..."

The contract between the letting authority and the successful bidder shall contain a statement requiring that mechanics and laborers be paid a prevailing rate of wage as required in Section 4115.06, Ohio Revised Code.

The contractor or subcontractor is required to file with the contracting public authority upon completion of the project and prior to final payment therefore an affidavit stating that he has fully complied with Chapter 4115 of the Ohio Revised Code.

The wage rates contained in this schedule are the "Prevailing Wages" as defined by Section 4115.03, Ohio Revised Code (the basic hourly rates plus certain fringe benefits). These rates and fringes shall be a minimum to be paid under a contract regulated by Chapter 4115 of the Ohio Revised Code by contractors and subcontractors. The prevailing wage rates contained in this schedule include the effective dates and wage rates currently on file. In cases where future effective dates are not included in this schedule, modifications to the wage schedule will be furnished to the Prevailing Wage Coordinator appointed by the public authority as soon as prevailing wage rates increases are received by this office.

"There shall be posted in a prominent and accessible place on the site of work a legible statement of the Schedule of Wage Rates specified in the contract to the various classifications of laborers, workmen, and mechanics employed, said statement to remain posted during the life of such contract." Section 4115.07, Ohio Revised Code.

Apprentices will be permitted to work only under a bona fide apprenticeship program if such program exists and if such program is registered with the Ohio Apprenticeship Council.

Section 4115.071 provides that no later than ten days before the first payment of wages is due to any employee of any contractor or subcontractor working on a contract regulated by Chapter 4115, Ohio Revised Code, the contracting public authority shall appoint one of his own employees to act as the prevailing wage coordinator for said contract. The duties of the prevailing wage coordinator are outlined in Section 4115.071 of the Ohio Revised Code.

Section 4115.05 provides for an escalator in the prevailing wage rate. Each time a new rate is established, that rate is required to be paid on all ongoing public improvement projects.

A further requirement of Section 4115.05 of the Ohio Revised Code is: "On the occasion of the first pay date under a contract, the contractor shall furnish each employee not covered by a collective bargaining agreement or understanding between employers and bona fide organizations of Labor with individual written notification of the job classification to which the employee is assigned, the prevailing wage determined to be applicable to that classification, separated into the hourly rate of pay and the fringe payments, and the identity of the prevailing wage Coordinator appointed by the public authority. The contractor or subcontractor shall furnish the same notification to each affected employee every time the job classification of the employee is changed."

Work performed in connection with the installation of modular furniture may be subject to prevailing wage.

THIS PACKET IS NOT TO BE SEPARATED BUT IS TO REMAIN COMPLETE AS IT IS SUBMITTED TO YOU. (Reference guidelines and forms are included in this packet to be helpful in the compliance of the Prevailing Wage law.)

wh1500

Thereafter, every third additional carpenter hired shall be an apprentice, if available, and if practical for the type of work being performed.

Special Jurisdictional Note : **Highway Construction, Airport Construction, Heavy Construction but not limited to: (Tunnels, subways, drainage projects, flood control, reservoirs). Railroad Construction, Sewer Waterworks & Utility Construction but not limited to: (storm sewers, waterlines, gaslines). Industrial & Building site, Power Plant, Amusement Park, Athletic stadium site, Sewer and Water Plants. When the contractor furnishes the necessary underwater gear for the diver, the diver shall be paid one and one half (1 & 1/2) times the journeyman rate for the time spent in the water.

Details :

For Review Only
Official Bid Packet available at
Athens County Engineer's Office

MIAMI, MONROE, MONTGOMERY, MORGAN,
MORROW, MUSKINGUM, NOBLE, OTTAWA,
PAULDING, PERRY, PICKAWAY, PIKE, PORTAGE,
PREBLE, PUTNAM, RICHLAND, ROSS, SANDUSKY,
SCIOTO, SENECA, SHELBY, STARK, SUMMIT,
TRUMBULL, TUSCARAWAS, UNION, VAN WERT,
VINTON, WARREN, WASHINGTON, WAYNE

Special Jurisdictional Note :

Details :

(A) Highway Construction, Sewer, Waterworks And Utility Construction, Industrial & Building Site Heavy Construction, Airport Construction Or Railroad Construction Work.

(B) Power Plant, Tunnels, Amusement Park, Athletic Stadium Site Work ,Pollution Control,Sewer Plant, Waste Plant, & Water Treatment Facilities, Construction.

*For Review Only
Official Bid Packet available at
Athens County Engineer's Office*

MAHONING, MARION, MEDINA, MEIGS, MERCER,
MIAMI, MONROE, MONTGOMERY, MORGAN,
MORROW, MUSKINGUM, NOBLE, OTTAWA,
PAULDING, PERRY, PICKAWAY, PIKE, PORTAGE,
PREBLE, PUTNAM, RICHLAND, ROSS, SANDUSKY,
SCIOTO, SENECA, SHELBY, STARK, SUMMIT,
TRUMBULL, TUSCARAWAS, UNION, VAN WERT,
VINTON, WARREN, WASHINGTON, WAYNE

Special Jurisdictional Note :

Details :

(A) Highway Construction, Sewer, Waterworks And Utility Construction, Industrial & Building Site Heavy Construction, Airport Construction Or Railroad Construction Work.

(B) Power Plant, Tunnels, Amusement Park, Athletic Stadium Site Work ,Pollution Control,Sewer Plant, Waste Plant, & Water Treatment Facilities, Construction.

For Review Only
Official Bid Packet available at
Athens County Engineer's Office

Construction, Airport Construction Or Railroad Construction Work.

Details :

For Review Only
Official Bid Packet available at
Athens County Engineer's Office

Details :

For Review Only
Official Bid Packet available at
Athens County Engineer's Office

HARRISON, HENRY, HIGHLAND, HOCKING,
HOLMES, JACKSON, JEFFERSON, KNOX,
LAWRENCE, LICKING, LOGAN, MADISON,
MARION, MEIGS, MERCER, MIAMI, MONROE,
MONTGOMERY, MORGAN, MORROW,
MUSKINGUM, NOBLE, PAULDING, PERRY,
PICKAWAY, PIKE, PREBLE, PUTNAM, RICHLAND,
ROSS, SCIOTO, SENECA, SHELBY, TUSCARAWAS,
UNION, VAN WERT, VINTON, WARREN,
WASHINGTON, WAYNE, WILLIAMS, WYANDOT

Special Jurisdictional Note : Hod Carriers and Common Laborers - Heavy, Highway, Sewer, Waterworks, Utility, Airport, Railroad, Industrial and Building Site, Sewer Plant, Waste Water Treatment Facilities Construction

Details :

Group 1

Laborer (Construction); Plant Laborer or Yardman, Right-of-way Laborer, Landscape Laborer, Highway Lighting Worker, Signalization Worker, (Swimming) Pool Construction Laborer, Utility Man, *Bridge Man, Handyman, Joint Setter, Flagperson, Carpenter Helper, Waterproofing Laborer, Slurry Seal, Seal Coating, Surface Treatment or Road Mix Laborer, Riprap Laborer & Grouter, Asphalt Laborer, Dump Man (batch trucks), Guardrail & Fence Installer, Mesh Handler & Placer, Concrete Curing Application, Scaffold Erector, Sign Installer, Hazardous Waste (level D), Diver Helper, Zone Person and Traffic Control.

*Bridge Man will perform work as per the October 31, 1949, memorandum on concrete forms, by and between the United Brotherhood of Carpenters and Joiners of America and the Laborers' International Union of North America, which states in; "the moving, cleaning, oiling and carrying to the next point of erection, and the stripping of forms which are not to be re-used, and forms on all flat arch work shall be done by members of the Laborers' International Union of North America."

Group 2

Asphalt Raker, Screwman or Paver, Concrete Puddler, Kettle Man (pipeline), All Machine-Driven Tools (Gas, Electric, Air), Mason Tender, Brick Paver, Mortar Mixer, Skid Steer, Sheeting & Shoring Person, Surface Grinder Person, Screedperson, Water Blast, Hand Held Wand, Power Buggy or Power Wheelbarrow, Paint Stripper, Plastic fusing Machine Operator, Rodding Machine Operator, Pug Mill Operator, Operator of All Vacuum Devices Wet or Dry, Handling of all Pumps 4 inches and under (gas, air or electric), Diver, Form Setter, Bottom Person, Welder Helper (pipeline), Concrete Saw Person, Cutting with Burning Torch, Pipe Layer, Hand Spiker (railroad), Underground Person (working in sewer and waterline, cleaning, repairing and reconditioning). Tunnel Laborer (without air), Caisson, Cofferdam (below 25 feet deep), Air Track and Wagon Drill, Sandblaster Nozzle Person, Hazardous Waste (level B), ***Lead Abatement, Hazardous Waste (level C)

***Includes the erecting of structures for the removal, including the encapsulation and containment of Lead abatement process.

Group 3

Blast and Powder Person, Muckers will be defined as shovel men working directly with the miners, Wrencher (mechanical joints & utility pipeline), Yarnier, Top Lander, Hazardous Waste (level A), Concrete Specialist, Curb Setter and Cutter, Grade Checker, Concrete Crew in Tunnels. Utility pipeline Tappers, Waterline, Caulker, Signal Person will receive the rate equal to the rate paid the Laborer classification for which the Laborer is signaling.

Group 4

Miner, Welder, Gunitite Nozzle Person

A.) The Watchperson shall be responsible to patrol and maintain a safe traffic zone including but not limited to barrels, cones, signs, arrow boards, message boards etc.

The responsibility of a watchperson is to see that the equipment, job and office trailer etc. are secure.

For Review Only
Official Bid Packet available at
Athens County Engineer's Office

Prevailing Wage Rate Skilled Crafts

Name of Union: Labor Local 83

Change # : LCN01-2016fbLoc83

Craft : Laborer Effective Date : 06/01/2016 Last Posted : 05/20/2016

	BHR		Fringe Benefit Payments					Irrevocable Fund		Total PWR	Overtime Rate	
			H&W	Pension	App Tr.	Vac.	Annuity	Other	LECET (*)			MISC (*)
Classification												
Laborer Group 1	\$34.11		\$6.70	\$3.20	\$0.40	\$0.00	\$0.00	\$0.00	\$0.15	\$0.28	\$44.84	\$61.90
Group 2	\$34.36		\$6.70	\$3.20	\$0.40	\$0.00	\$0.00	\$0.00	\$0.15	\$0.28	\$45.09	\$62.27
Group 3	\$34.51		\$6.70	\$3.20	\$0.40	\$0.00	\$0.00	\$0.00	\$0.15	\$0.28	\$45.24	\$62.50
Apprentice	Percent											
0-1000 hrs	60.00	\$20.47	\$6.70	\$3.20	\$0.40	\$0.00	\$0.00	\$0.00	\$0.15	\$0.28	\$31.20	\$41.43
1001-2000 hrs	70.00	\$23.88	\$6.70	\$3.20	\$0.40	\$0.00	\$0.00	\$0.00	\$0.15	\$0.28	\$34.61	\$46.55
2001-3000 hrs	80.00	\$27.29	\$6.70	\$3.20	\$0.40	\$0.00	\$0.00	\$0.00	\$0.15	\$0.28	\$38.02	\$51.66
3001-4000 hrs	90.00	\$30.70	\$6.70	\$3.20	\$0.40	\$0.00	\$0.00	\$0.00	\$0.15	\$0.28	\$41.43	\$56.78
More than 4000 hrs	100.00	\$34.11	\$6.70	\$3.20	\$0.40	\$0.00	\$0.00	\$0.00	\$0.15	\$0.28	\$44.84	\$61.90

Special Calculation Note : No special calculations for this skilled craft wage rate are required at this time.

Ratio :

1 Journeymen to 1 Apprentice
4 Journeymen to 1 Apprentice

Jurisdiction (* denotes special jurisdictional note) :

ADAMS, ATHENS, GALLIA, HIGHLAND, JACKSON, LAWRENCE, MEIGS, PIKE, ROSS, SCIOTO, VINTON

Special Jurisdictional Note :

Details :

Group 1
Building & Construction Laborers, Signalman, Plaster Tenders, Carpenter Tenders, Mason Tenders, Mortar Mixers, Pipe Layers, Bottom Man, Sheeting & Shoring Men, Watchmen & Waterboy.

Group 2

Air & Machine Driver Tool Operators, Hand Spikers, Chain Saws, Powered Concrete Buggies, Asphalt Rakers & Smoothers, Form Setters (Street & Highway) Burning & Cutting Torches

Group 3

Gunnite Machine Operator, Gunnite Nozzle Man, Powder Men & Blasters, Miners (Tunnel & Caisson) Muckers (Tunnel & Caisson).

All Hazardous & High Work performed in excess of 25 ft. above solid base shall pay .25 per hour above Classification.

In the erection, alteration, repair or demolition of reinforced concrete chimneys, masonry chimneys, silos, and furnaces, the following rates shall apply:

25- 100 ft. \$1.00 per hour/over base rate 150-200 ft. \$1.50 per hour/over base rate
100-150 ft. \$1.25 per hour/over base rate 200-250 ft. \$1.75 per hour/over base rate
Over 250 ft. \$2.00 per hour/over base rate

For Review Only
Official Bid Packet available at
Athens County Engineer's Office

Prevailing Wage Rate Skilled Crafts

Name of Union: Operating Engineers - Building Local 18 - Zone III

Change # : LCN01-2016fbLoc18zone3

Craft : Operating Engineer Effective Date : 06/01/2016 Last Posted : 06/01/2016

	BHR		Fringe Benefit Payments					Irrevocable Fund		Total PWR	Overtime Rate	
			H&W	Pension	App Tr.	Vac.	Annuity	Other	LECET (*)			MISC (*)
Classification												
Operator Class 1	\$33.84		\$7.66	\$6.00	\$0.75	\$0.00	\$0.00	\$0.09	\$0.00	\$0.00	\$48.34	\$65.26
Class 2	\$32.72		\$7.66	\$6.00	\$0.75	\$0.00	\$0.00	\$0.09	\$0.00	\$0.00	\$47.22	\$63.58
Class 3	\$32.68		\$7.66	\$6.00	\$0.75	\$0.00	\$0.00	\$0.09	\$0.00	\$0.00	\$47.18	\$63.52
Class 4	\$31.50		\$7.66	\$6.00	\$0.75	\$0.00	\$0.00	\$0.09	\$0.00	\$0.00	\$46.00	\$61.75
Class 5	\$26.04		\$7.66	\$6.00	\$0.75	\$0.00	\$0.00	\$0.09	\$0.00	\$0.00	\$40.54	\$53.56
Class 6	\$34.09		\$7.66	\$6.00	\$0.75	\$0.00	\$0.00	\$0.09	\$0.00	\$0.00	\$48.59	\$65.64
Class 7	\$34.34		\$7.66	\$6.00	\$0.75	\$0.00	\$0.00	\$0.09	\$0.00	\$0.00	\$48.84	\$66.01
Class 8	\$34.84		\$7.66	\$6.00	\$0.75	\$0.00	\$0.00	\$0.09	\$0.00	\$0.00	\$49.34	\$66.76
Class 9	\$35.09		\$7.66	\$6.00	\$0.75	\$0.00	\$0.00	\$0.09	\$0.00	\$0.00	\$49.59	\$67.14
Apprentice	Percent											
1st Year	50.00	\$16.92	\$7.66	\$6.00	\$0.75	\$0.00	\$0.00	\$0.09	\$0.00	\$0.00	\$31.42	\$39.88
2nd Year	60.00	\$20.30	\$7.66	\$6.00	\$0.75	\$0.00	\$0.00	\$0.09	\$0.00	\$0.00	\$34.80	\$44.96
3rd Year	70.00	\$23.69	\$7.66	\$6.00	\$0.75	\$0.00	\$0.00	\$0.09	\$0.00	\$0.00	\$38.19	\$50.03
4th Year	80.00	\$27.07	\$7.66	\$6.00	\$0.75	\$0.00	\$0.00	\$0.09	\$0.00	\$0.00	\$41.57	\$55.11
Field Mechanic Trainee												
1st Year	50.00	\$16.92	\$7.66	\$6.00	\$0.75	\$0.00	\$0.00	\$0.09	\$0.00	\$0.00	\$31.42	\$39.88
2nd Year	60.00	\$20.30	\$7.66	\$6.00	\$0.75	\$0.00	\$0.00	\$0.09	\$0.00	\$0.00	\$34.80	\$44.96
3rd Year	70.00	\$23.69	\$7.66	\$6.00	\$0.75	\$0.00	\$0.00	\$0.09	\$0.00	\$0.00	\$38.19	\$50.03
4th Year	80.00	\$27.07	\$7.66	\$6.00	\$0.75	\$0.00	\$0.00	\$0.09	\$0.00	\$0.00	\$41.57	\$55.11

Special Calculation Note : Other: Education & Safety

Ratio :

For every (3) Operating Engineer Journeymen employed by the company ,there may be employed (1) Registered Apprentice. An apprenice, while employed as part of a crew per Article VIII, paragraph 77, will not be subject to the apprenticeship ratios in this collective bargaining

Jurisdiction (* denotes special jurisdictional note) :

ADAMS, ALLEN, ASHLAND, ATHENS, AUGLAIZE, BELMONT, BROWN, BUTLER, CARROLL, CHAMPAIGN, CLARK, CLERMONT, CLINTON, COSHOCTON, CRAWFORD, DARKE, DEFIANCE, DELAWARE, FAIRFIELD, FAYETTE, FRANKLIN,

agreement. On jobs where maintenance engineers are to be employed, for every (2) Class 2 Mechanics there may be (1) Mechanic Trainee & so fourth.

FULTON, GALLIA, GREENE, GUERNSEY, HAMILTON, HANCOCK, HARDIN, HARRISON, HENRY, HIGHLAND, HOCKING, HOLMES, JACKSON, JEFFERSON, KNOX, LAWRENCE, LICKING, LOGAN, MADISON, MARION, MEIGS, MERCER, MIAMI, MONROE, MONTGOMERY, MORGAN, MORROW, MUSKINGUM, NOBLE, OTTAWA, PAULDING, PERRY, PICKAWAY, PIKE, PREBLE, PUTNAM, RICHLAND, ROSS, SANDUSKY, SCIOTO, SENECA, SHELBY, STARK, TUSCARAWAS, UNION, VAN WERT, VINTON, WARREN, WASHINGTON, WAYNE, WILLIAMS, WYANDOT

Special Jurisdictional Note :

Details :

**Apprentices will receive a 10% increase on top of the percentages listed above provided they are operating mobile equipment. Mechanic Trainees will receive 10% increase if required to have CDL

Class 1 - Barrier Moving Machine; Boiler Operators or Compressor Operators, when compressor or boiler is mounted on crane (Piggyback Operation); Boom Trucks (all types); Caissons; Cherry Pickers; Combination - Concrete Mixers & Towers; All Concrete Pumps with Booms; Cranes (all types) Derricks (all types); Draglines Dredges (dipper, clam or suction) 3-man crew; Elevating Graders or Euclid Loaders; Floating Equipment; Gradalls; Helicopter Operators; hoisting building materials; Helicopter Winch Operators, Hoisting building materials; Hoes (All types); Hoists (with two or more drums in use); Hydraulic Gantry (lift system); Laser Finishing Machines; Lift Slab or Panel Jack Operators; Locomotives (all types); Maintenance Engineers (Mechanic and/or Welder); Mixers, paving (multiple drum); Mobile Concrete Pumps, with booms, Panelboards, (all types on site); Pile Drivers; Power Shovels; Prentice Loader; Rail Tamper (with automatic lifting and aligning device); Rotary Drills (all) used on caissons for foundations and sub-structure work; Side Booms; Slip Form Pavers; Straddle Carriers (Building Construction on site); Tug Boats. Horizontal Directional Drill, Rough Terrain Fork-lift with Winch/Hoist, Laser Screed, and Like equipment; Compact Cranes, track or rubber over 4,000 pound capacity, self-erecting cranes: stationary, track or truck (all configurations) bucket trench machines (over 24 " wide).

Class 2 - Asphalt Pavers; Bobcat-type and/or skid steer loader with hoe attachment greater than 7000 lbs. Bulldozers; CMI type Equipment; Endloaders; Hydro Milling Machine; Kolman-type Loaders (Dirt Loading); Lead Greasemen; Mucking Machines; Pettibone-Rail Equipment; Power Graders; Power Scoops; Power Scrapers; Push Cats; Vermeer Type Concrete Saw; All rotomills, grinders & planers of all types. Articulating/end dumps (minus \$4.00/hour from Class 2 rate)

Class 3 - A Frames; Air Compressors, Pressurizing Shafts or Tunnels; All Asphalt Rollers; Bobcat-type and/or skid steer loader with or without attachments; Boilers (15 lbs pressure and over); All concrete Pumps (without booms with 5 inch system); Fork Lifts (except masonry); Highway Drillers - all types (with integral power); Hoists (with one drum); House Elevators (except those automatic call button controlled); Man lifts; Mud Jacks; Pressure Grouting; Pump Operators (installing or operating Well Points or other types of Dewatering Systems); Pumps (4 inches and over discharge); Railroad Tie Inserter/Remover; Rotator (Lime-Soil Stabilizer); Submersible Pumps (4 inches and over discharge); Switch & Tie Tampers (without lifting and aligning device); Trench Machines (24 inches and under); Utility Operators; Material hoist/elevators.

Class 4 - Ballast Re-locator; Backfillers and Tampers; Batch Plant Operators; Bar and Joint Installing Machines;

Bull Floats; Burlap and Curing Machines; Clefplanes; Compressors, on building construction; Concrete Spreader; Conveyors, used for handling building materials; Concrete Mixers, one bag capacity (side loader); Concrete Mixers, capacity more than one bag; Crushers; Deck Hands; Drum Fireman (in Asphalt Plant); Farm type tractors pulling attachments; Finishing Machines; Form Trenchers; Generators: Guniting Machines; Hydro-Seeders; Pavement Breakers (hydraulic or cable); Post Drivers; Post Hole Diggers; Pressure Pumps (over 1/2 inch discharge); Road Widening Trenchers; Rollers (except asphalt); All Concrete pumps (without Boom with 4 inch or smaller systems); Self-Propelled Power Spreaders; Concrete Spreaders; Self-Propelled Sub-graders; Shotcrete Machines; Tire Repairmen; Tractors, pulling sheepfoot rollers or graders; VAC/ALLS; Vibratory Compactors, with integral power; Welder Operators.

Class 5 - Boilers (less than 15 lbs. pressure); Inboard/outboard Motor Boat Launches; Light Plant Operators; Masonry Fork Lifts; Oilers/Helpers; Power Driven Heaters (oil fired); Power Scrubbers; Power Sweepers; Pumps (under 4 inch discharge); Signalmen, Submersible Pumps (under 4 inch discharge). Directional Drill Locator and Allen Screed Concrete Paver. Fueling and greasing (plus \$3.00), compact cranes; track or rubber under 4,000 pounds.

Class 6 - Master Mechanic

Class 7 - Boom & Jib 150 - 180 feet

Class 8 - Boom & Jib 180 - 249 feet

Class 9 - Boom & Jib 250 - or over

For Review Only
Official Bid Packet available at
Athens County Engineer's Office

Prevailing Wage Rate Skilled Crafts

Name of Union: Operating Engineers - HevHwy II

Change # : LCN01-2016fbLoc18hevhwyl

Craft : Operating Engineer Effective Date : 06/01/2016 Last Posted : 06/01/2016

	BHR		Fringe Benefit Payments					Irrevocable Fund		Total PWR	Overtime Rate	
			H&W	Pension	App Tr.	Vac.	Annuity	Other	LECET (*)			MISC (*)
Classification												
Operator Class 1	\$33.84		\$7.66	\$6.00	\$0.75	\$0.00	\$0.00	\$0.09	\$0.00	\$0.00	\$48.34	\$65.26
Class 2	\$33.72		\$7.66	\$6.00	\$0.75	\$0.00	\$0.00	\$0.09	\$0.00	\$0.00	\$48.22	\$65.08
Class 3	\$32.68		\$7.66	\$6.00	\$0.75	\$0.00	\$0.00	\$0.09	\$0.00	\$0.00	\$47.18	\$63.52
Class 4	\$31.50		\$7.66	\$6.00	\$0.75	\$0.00	\$0.00	\$0.09	\$0.00	\$0.00	\$46.00	\$61.75
Class 5	\$26.04		\$7.66	\$6.00	\$0.75	\$0.00	\$0.00	\$0.09	\$0.00	\$0.00	\$40.54	\$53.56
Class 6	\$34.09		\$7.66	\$6.00	\$0.75	\$0.00	\$0.00	\$0.09	\$0.00	\$0.00	\$48.59	\$65.64
Class 7	\$34.09		\$7.66	\$6.00	\$0.75	\$0.00	\$0.00	\$0.09	\$0.00	\$0.00	\$48.59	\$65.64
Class 8	\$34.34		\$7.66	\$6.00	\$0.75	\$0.00	\$0.00	\$0.09	\$0.00	\$0.00	\$48.84	\$66.01
Great Lakes Floating Agreement												
Class 1	\$41.90		\$7.41	\$6.00	\$0.75	\$0.00	\$0.00	\$0.09	\$0.00	\$0.00	\$56.15	\$77.10
Class 2A	\$40.40		\$7.41	\$6.00	\$0.75	\$0.00	\$0.00	\$0.09	\$0.00	\$0.00	\$54.65	\$74.85
Class 2B	\$40.40		\$7.41	\$6.00	\$0.75	\$0.00	\$0.00	\$0.09	\$0.00	\$0.00	\$54.65	\$74.85
Class 3	\$35.95		\$7.41	\$6.00	\$0.75	\$0.00	\$0.00	\$0.09	\$0.00	\$0.00	\$50.20	\$68.18
Class 4	\$29.90		\$7.41	\$6.00	\$0.75	\$0.00	\$0.00	\$0.09	\$0.00	\$0.00	\$44.15	\$59.10
Apprentice	Percent											
1st Year	50.00	\$16.92	\$7.66	\$6.00	\$0.75	\$0.00	\$0.00	\$0.09	\$0.00	\$0.00	\$31.42	\$39.88
2nd Year	60.00	\$20.30	\$7.66	\$6.00	\$0.75	\$0.00	\$0.00	\$0.09	\$0.00	\$0.00	\$34.80	\$44.96
3rd Year	70.00	\$23.69	\$7.66	\$6.00	\$0.75	\$0.00	\$0.00	\$0.09	\$0.00	\$0.00	\$38.19	\$50.03
4th Year	80.00	\$27.07	\$7.66	\$6.00	\$0.75	\$0.00	\$0.00	\$0.09	\$0.00	\$0.00	\$41.57	\$55.11
Field Mech Trainee Class 2												
1st year	49.82	\$16.86	\$7.66	\$6.00	\$0.75	\$0.00	\$0.00	\$0.09	\$0.00	\$0.00	\$31.36	\$39.79
2nd year	59.78	\$20.23	\$7.66	\$6.00	\$0.75	\$0.00	\$0.00	\$0.09	\$0.00	\$0.00	\$34.73	\$44.84
3rd year	69.73	\$23.60	\$7.66	\$6.00	\$0.75	\$0.00	\$0.00	\$0.09	\$0.00	\$0.00	\$38.10	\$49.89
4th year	79.73	\$26.98	\$7.66	\$6.00	\$0.75	\$0.00	\$0.00	\$0.09	\$0.00	\$0.00	\$41.48	\$54.97

Special Calculation Note : Other: Education & Safety Fund is \$0.09 per hour.

Ratio :

Jurisdiction (* denotes special jurisdictional

note) :

For every (3) Operating Engineer Journeymen employed by the company , there may be employed (1) Registered Apprentice. An apprentice, while employed as part of a crew per Article VIII paragraph 65, will not be subject the apprenticeship ratios in this collective bargaining agreement. On jobs where maintenance engineers are to be employed, for every (2) Class 2 Mechanics there may be (1) Mechanic Trainee & so fourth. Mechanic Trainee rate is a percentage of Class 2 rate.

ADAMS, ALLEN, ASHLAND, ATHENS, AUGLAIZE, BELMONT, BROWN, BUTLER, CARROLL, CHAMPAIGN, CLARK, CLERMONT, CLINTON, COSHOCTON, CRAWFORD, DARKE, DEFIANCE, DELAWARE, FAIRFIELD, FAYETTE, FRANKLIN, FULTON, GALLIA, GREENE, GUERNSEY, HAMILTON, HANCOCK, HARDIN, HARRISON, HENRY, HIGHLAND, HOCKING, HOLMES, HURON, JACKSON, JEFFERSON, KNOX, LAWRENCE, LICKING, LOGAN, LUCAS, MADISON, MARION, MEIGS, MERCER, MIAMI, MONROE, MONTGOMERY, MORGAN, MORROW, MUSKINGUM, NOBLE, OTTAWA, PAULDING, PERRY, PICKAWAY, PIKE, PREBLE, PUTNAM, RICHLAND, ROSS, SANDUSKY, SCIOTO, SENECA, SHELBY, STARK, TUSCARAWAS, UNION, VAN WERT, VINTON, WARREN, WASHINGTON, WAYNE, WILLIAMS, WOOD, WYANDOT

Special Jurisdictional Note :

Details :

**Apprentices will receive a 10% increase on top of the percentages listed above provided they are operating mobile equipment. Mechanic Trainees will receive 10% increase if they are required to have CDL.

Class 1 - Air Compressors on Steel Erection; Barrier Moving Machine; Boiler Operators, on Compressors or Generators, when mounted on a rig; Cableways, Combination Concrete mixers & Towers; Concrete Pumps; Concrete Plants (over 4 yd capacity); Cranes (all types, including Boom Trucks, Cherry Pickers); Derricks; Draglines, Dredgers (dipper, clam or suction); Elevating Graders or Euclid Loaders; Floating Equipment (all types); Gradalls, Helicopter Crew (Operator- hoist or winch); Hoes (all types); Hoisting Engines, on shaft or tunnel work; Hydraulic Gantry (lifting system); Industrial - Type Tractors; Jet Engine Dryers (D8 or D9), Diesel Tractors; Locomotives (standard gage); Maintenance Operators (class A); Mixers, paving (single or double drum); Mucking Machines; Multiple Scrapers; Piledriving Machines (all types); Power Shovels, Prentice Loader; Quad 9 (double pusher); Rail Tamper (with automatic lifting and aligning device); Refrigerating Machines (freezer operation); Side Booms; Slip Form Pavers; Tower Dericks; Tree Shredders; Truck Mounted Concrete Pumps; Tug Boats; Tunnel Machines and /or Mining Machines; Wheel Excavators. Rough Terrain Fork-lift with Winch/Hoist; Compact Cranes, track rubber over 4,000 pound capacity, self-erecting cranes; stationary, track or truck (all configurations) Bucket trench machines (over 24 inches wide).

Class 2 - Asphalt Pavers; Automatic Subgrade Machines, self-propelled (CMI-type); Bobcat-type and /or skid steer loader with hoe attachment greater than 7000 lbs.; Boring Machine Operators (more than 48 inches); Bulldozers; Endloaders; Hydro Milling Machine; Kolman-type Loaders (production type-dirt); Lead Greasemen; Maintenance Operators, Class B (Portage and Summit Counties only); Pettibone-Rail Equipment; Power Graders; Power Scrapers; Push Cats; Lighting and Traffic Signal Installation Equipment includes all groups or classifications; Trench Machines (24inch wide and under); Vermeer Type Concrete saw. Material Transfer Equipment (Shuttle buggy) Asphalt; All rotomills,grinders and planers of all types. Horizontal Directional Drill (Over 50,000 ft.lbs.thrust and over)

Class 3 - A-Frames; Air Compressors, on tunnel work (low Pressure); Asphalt Plant Engineers; Bobcat-type and/or

skid steer loader with or without attachments; Power Boilers (15 lbs pressure and over); Highway Drills (all types); Rollers, asphalt; Pump Operators (installing or operating well Points); Pumps (4 inch and over discharge); Railroad Tie Inserter/Remover; Rotator (lime-soil Stabilizer), Switch & Tie Tampers (without lifting and aligning device); Locomotives (narrow gage); Mixers, concrete (more than one bag capacity); Mixers, one bag capacity (side loader); Utilities Operators, (small equipment); Welding Machines; Material hoist/elevators. Articulating/straight bed end dumps if assigned (minus \$4.00 per hour).

Class 4 -Ballast Re-locator; Backfillers, Batch Plants; Bar and Joint Installing Machines; Boring Machine Operators (48 inch or less); Bull Floats; Burlap and Curing Machines; Concrete Plants (capacity 4 yd and under); Conveyors (highway); Concrete Saws (multiple); Crushers; Deckhands; Farm type tractors, with attachments (highway), except masonry; Finishing Machines; Firemen, Floating Equipment (all types); Fork Lifts (highway); Form Trenchers; Hydro Hammers; Hydro Seeders; Pavement Breakers; Plant Mixers; Post Drivers; Post Hole Diggers (power auger); Power Brush Burners; Power Form Handling Equipment; Road Widening Trenchers; Rollers (brick, grade, macadam); Self-Propelled Power Spreaders; Self-Propelled Sub-Graders; Tractors, pulling sheepsfoot rollers or graders; Steam Firemen; Vibratory Compactors, with integral power.

Class 5 - Compressors (portable, Sewer, Heavy and Highway); Generators; Inboard-Outboard Motor Boat Launches; Masonry Fork Lifts; Oilers/Helpers; Power Driven Heaters; Power Scrubbers; Power Sweepers; Pumps (under 4 inch discharge); Signalmen; Drum Fireman (in Asphalt Plant); Oil Heaters (Asphalt Plant); Tire Repairmen; VAC/ALLS; Fueling and greasing (plus \$3.00), compact cranes, track or rubber under 4,000 pounds.

Class 6 - Master Mechanic

Class 7 - Crane Boom 150 ft - 180 ft

Class 8 - Crane Boom over 180 ft .

GREAT LAKES FLOATING AGREEMENT:

Class 1 - Diver, Wet Tender, Engineer, (Hyd. Dredge), Craft Foreman (Master Mechanic)

Class 2A - Crane Backhoe Operator, Mechanic/Welder, Assistant Engineer (Hyd. Dredge), Leverman (Hyd Dredge) Diver Tender, Tug Operator (Tug 70T and over)

Class 2B - Friction Crane, Lattice Boom or any Crane Certification.

Class 3 - Deck Equipment Operator, (Machineryman), Maint. of Crane, Tug/Launch Operator, Loader/Dozer on Barge, Deck Machinery, Maintenance of Crane (over 50T capacity), or Backhoe (115,000lbs or more) Loaders/Dozer and like equipment on Barge, Breakwater Wall, Slip/Dock Scow.

Class 4 - Deck Equipment Operator, (Machineryman/Fireman)(4 equipment Units or more), Deck Hand, Tug Engineer, Crane Maintenance, 50T and under/Backhoe 115,000lbs or less, Assistant Tug Operator, add off Road Truck.

LICKING, LOGAN, LORAIN, LUCAS, MADISON,
MAHONING, MARION, MEDINA, MEIGS, MERCER,
MIAMI, MONROE, MONTGOMERY, MORGAN,
MORROW, MUSKINGUM, NOBLE, OTTAWA,
PAULDING, PERRY, PICKAWAY, PIKE, PORTAGE,
PREBLE, PUTNAM, RICHLAND, ROSS, SANDUSKY,
SCIOTO, SENECA, SHELBY, STARK, SUMMIT,
TRUMBULL, TUSCARAWAS, UNION, VAN WERT,
VINTON, WARREN, WASHINGTON, WAYNE,
WILLIAMS, WOOD, WYANDOT

Special Jurisdictional Note :

Details :

Top Helper: Shall perform the responsibilities of a Helper and be responsible for the setup, break down, safety and quality of the company's product.

Helper : Shall be responsible for performing tasks in refinishing, compliance with safety procedures, setting up and breaking down job sites, scaffolding and swing stages and preparing surfaces for refinishing including but not limited to, masking and stripping and cleaning, oxidizing, polishing and scratch removal on various surfaces

Class A Workers: Less than 1 Year of Service.

Class B Workers: More than 1 and less than 8 Years of Service

Class C Workers: More than 8 Years of Service.

Metal Polisher Scope of Work: Polishing, buffing, stripping, coloring, lacquering, spraying, cleaning and maintenance of ornamental and architectural metals, iron, bronze, nickel, aluminum and stainless steel and in mental specialty work, various stone finishes, stone specialty work and any other work pertaining to the finishing of metal, stones, woods, and any window washing/cleaning done in conjunction with this work, using chemicals, solvents, coatings and hand applied lacquer thinner, removing scratches from mirror finished metals, burnishing of bronze, statuary finishes on exterior and interior surfaces and the use of all tools required to perform such work, including but not limited to polishes, spray equipment and scaffolding.

Swing State Rate: All work on scaffold 4 sections or higher, including any boom lifts and swing stage scaffolds including the rigging and derigging of hanging/suspended swing stage systems and rappelling/bolson chair work, ADD \$1.50 per hour.

upon Commercial Rate calculation. Please adjust accordingly for Industrial, Bridges, and High Tension.

Ratio :

1 Journeyman to 1 Apprentice
3 Journeyman to 1 Apprentice thereafter

Jurisdiction (* denotes special jurisdictional note) :

ATHENS, GUERNSEY, HOCKING, MONROE,
MORGAN, NOBLE, WASHINGTON

Special Jurisdictional Note :

Details :

Commercial work shall apply to all painting, coatings, drywall finishing, and wall covering performed on commercial structures, water and sewage treatment facilities, and all new and existing steel prefabricated buildings, and office facilities within the confines of a plant not used for manufacturing purposes (this does not include sites where any special agreements are in place.) It shall also apply to any and all water storage tanks.

Industrial Work but not limited to: all work done within the confines of a manufacturing plant, mining facilities, on all skeleton steel structures, storage tanks of any kind and plant work.

For Review Only
Official Bid Packet available at
Athens County Engineer's Office

3 Journeymen to 1 Apprentice
per company/project

ADAMS, ALLEN, ASHLAND, ASHTABULA,
ATHENS, AUGLAIZE, BELMONT, BROWN,
BUTLER, CARROLL, CHAMPAIGN, CLARK,
CLERMONT, CLINTON, COLUMBIANA,
COSHOCTON, CRAWFORD, DARKE, DEFIANCE,
DELAWARE, ERIE, FAIRFIELD, FAYETTE,
FRANKLIN, FULTON, GALLIA, GREENE,
GUERNSEY, HAMILTON, HANCOCK, HARDIN,
HARRISON, HENRY, HIGHLAND, HOCKING,
HOLMES, HURON, JACKSON, JEFFERSON, KNOX,
LAWRENCE, LICKING, LOGAN, LORAIN, LUCAS,
MADISON, MAHONING, MARION, MEDINA,
MEIGS, MERCER, MIAMI, MONROE,
MONTGOMERY, MORGAN, MORROW,
MUSKINGUM, NOBLE, OTTAWA, PAULDING,
PERRY, PICKAWAY, PIKE, PORTAGE, PREBLE,
PUTNAM, RICHLAND, ROSS, SANDUSKY, SCIOTO,
SENECA, SHELBY, STARK, SUMMIT, TRUMBULL,
TUSCARAWAS, UNION, VAN WERT, VINTON,
WARREN, WASHINGTON, WAYNE, WILLIAMS,
WOOD, WYANDOT

Special Jurisdictional Note :

Details :

** Asphalt - Oil spray bar man when operating from cab shall receive \$0.20 cents per hour above their Basic Hourly Rate.

For Review Only
Official Bid Packet available at
Athens County Engineer's Office

3 Journeymen to 1 Apprentice
per company/project

ADAMS, ALLEN, ASHLAND, ASHTABULA,
ATHENS, AUGLAIZE, BELMONT, BROWN,
BUTLER, CARROLL, CHAMPAIGN, CLARK,
CLERMONT, CLINTON, COLUMBIANA,
COSHOCTON, CRAWFORD, DARKE, DEFIANCE,
DELAWARE, ERIE, FAIRFIELD, FAYETTE,
FRANKLIN, FULTON, GALLIA, GREENE,
GUERNSEY, HAMILTON, HANCOCK, HARDIN,
HARRISON, HENRY, HIGHLAND, HOCKING,
HOLMES, HURON, JACKSON, JEFFERSON, KNOX,
LAWRENCE, LICKING, LOGAN, LORAIN, LUCAS,
MADISON, MAHONING, MARION, MEDINA,
MEIGS, MERCER, MIAMI, MONROE,
MONTGOMERY, MORGAN, MORROW,
MUSKINGUM, NOBLE, OTTAWA, PAULDING,
PERRY, PICKAWAY, PIKE, PORTAGE, PREBLE,
PUTNAM, RICHLAND, ROSS, SANDUSKY, SCIOTO,
SENECA, SHELBY, STARK, SUMMIT, TRUMBULL,
TUSCARAWAS, UNION, VAN WERT, VINTON,
WARREN, WASHINGTON, WAYNE, WILLIAMS,
WOOD, WYANDOT

Special Jurisdictional Note :

Details :

** Asphalt - Oil spray bar man when operating from cab shall receive \$0.20 cents per hour above their Basic Hourly Rate.

For Review Only
Official Bid Packet available at
Athens County Engineer's Office