



ATHENS COUNTY ENGINEER'S OFFICE

Jeff Maiden, P.E., P.S., Athens County Engineer
16000 Canaanville Road Athens, Ohio 45701
Office (740) 593-5514 • Fax (740) 592-4616

ADDENDUM #1—AUGUST 18, 2021

MANSFIELD ROAD RECONSTRUCTION PROJECT PROJECT NO. 21161 ATHENS COUNTY, OHIO

1. See attached drawing “Addendum #1: Full Depth Repair – Base Stabilization” enclosed. The limits of the project were changed and the length of base stabilization and paving is now 0.72 miles.
2. See the revised bid sheets attached. Quantities were updated for the Cement Stabilized Subgrade and paving to reflect the new project limits, as described in item 2 above. Contractors are to use these supplied sheets to bid the project.
3. The revised Engineer’s Construction Cost Estimate is \$ 181,500.

THIS ADDENDUM MUST BE ACKNOWLEDGED ON PAGE 1 OF “SECTION II” OF THE BID DOCUMENTS (BID PROPOSAL).

SUBMITTED BY:

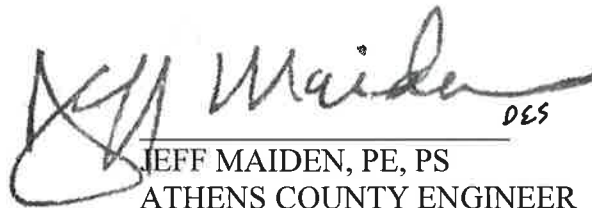
A handwritten signature in black ink that reads "Jeff Maiden". To the right of the signature, the initials "DES" are written in a smaller, simpler font.

JEFF MAIDEN, PE, PS
ATHENS COUNTY ENGINEER

ADDENDUM 1: FULL DEPTH REPAIR – BASE STABILIZATION

MANSFIELD ROAD
RECONSTRUCTION PROJECT

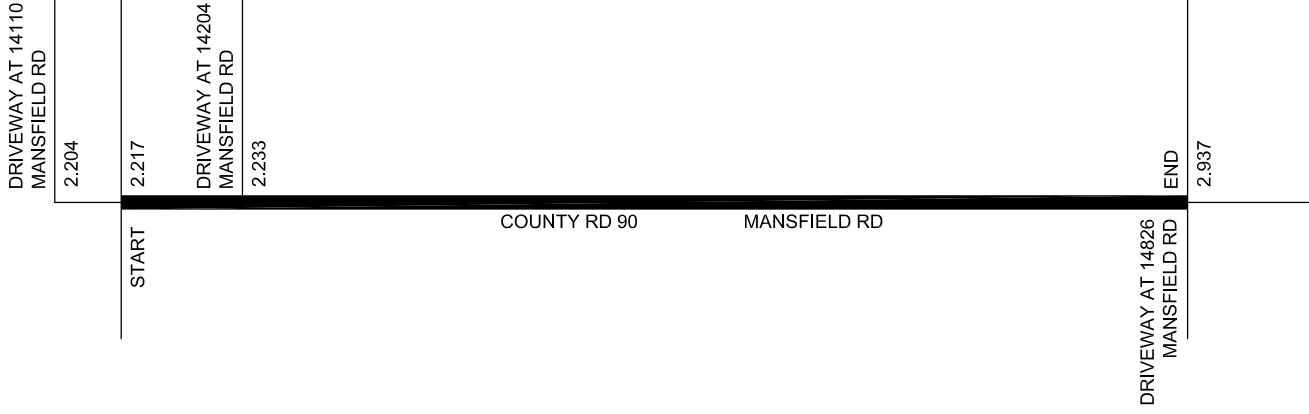

FULL DEPTH REPAIR AND PAVEMENT CALCULATIONS

LOCATION	ROUTE	ROAD NAME	LOG POINT TO LOG POINT		LENGTH	LENGTH	AVERAGE	SURFACE AREA	AREA	Cement Stabilized Subgrade, 9 inches deep	Portland Cement (71#/SY)	Curing Coat	2" - Asphalt Concrete Intermediate Course, Type 2 (448)	Compacted Aggregate
			MILE	MILE	MILES	FT	FT	SY	SY					
FULL DEPTH REPAIR														
1	90	Mansfield	2.217	2.937	0.72	3802	20	8448		8448	300	8448		
PAVING														
1	90	Mansfield	2.217	2.937	0.72	3802	18	7603					423	47
TOTALS										8448	300	8448	423	47

CONTRACTOR: _____

**UNIT PRICE BID FORM
MANSFIELD ROAD RECONSTRUCTION PROJECT**

REF #	ITEM	ITEM DESCRIPTION	QTY	UNIT	UNIT PRICE	ITEM TOTAL
1	206	Cement Stabilized Subgrade, 9 inches deep	8,448	SY	\$	\$
2	206	Cement	300	TON	\$	\$
3	206	Curing Coat	8,448	SY	\$	\$
4	441	Asphalt Concrete Intermediate Course, Type 2 (448)	423	CY	\$	\$
5	617	Compacted Aggregate	47	CY	\$	\$
6	103	Premium for Performance Bond and for Payment Bond	1	LS	\$	\$
7	614	Maintaining Traffic	1	LS	\$	\$
8	623	Construction Layout Stakes	1	LS	\$	\$
9	624	Mobilization	1	LS	\$	\$

TOTAL \$ _____

Grand Total Project in Words _____

UNIT PRICE shall govern over TOTAL in case of discrepancy. If the plans or other quantity estimates shown herein differ from this unit price bid form, bid as shown on this sheet. Final payment will be based on actual quantities at the bid unit price.

Bidder understands that the owner reserves the right to reject any or all bids and to waive any informalities in the bidding.

The bidder agrees that this bid shall be good and may not be withdrawn for a period of 60 calendar days after the scheduled closing time for receiving bids.

Upon receipt of written notice of the acceptance of this bid, bidder will execute the formal contract attached within 10 days and deliver a Surety Bond or Bonds as required by the Contract Documents. The bid security attached is to become the property of the owner in the event the contract and bond are not executed within the time above set forth, as liquidated damages for the delay and additional expense to the owner caused thereby.