

LOCATION MAP

COUNTY GARAGE - LATITUDE: N39°19'27" LONGITUDE: W81°59'34"

ATHENS COUNTY ENGINEER

ATH CR VAR RESURF FY23

PROJECT DESCRIPTION

ASPHALT RESURFACING VARIOUS ATHENS COUNTY ROADS WITH AN ASPHALT LEVELING COURSE AND AN ASPHALT SURFACE COURSE AND RESURFACING VARIOUS ATHENS COUNTY ROADS BY PLACING 2.5" THICK OF MOTOR PAVING CONSISTING OF #57 STONE AND ASPHALT EMULSION. ALSO PLACE #8 CHIP SEAL.

PROJECT EARTH DISTURBED AREA: N/A (Maintenance Project)
 ESTIMATED CONTRACTOR EARTH DISTURBED AREA: N/A (Maintenance Project)
 NOTICE OF INTENT EARTH DISTURBED AREA: N/A (Maintenance Project)

2019 SPECIFICATIONS

THE STANDARD SPECIFICATIONS OF THE STATE OF OHIO, DEPARTMENT OF TRANSPORTATION, INCLUDING CHANGES AND SUPPLEMENTAL SPECIFICATIONS LISTED IN THE PROPOSAL SHALL GOVERN THIS IMPROVEMENT.

I HEREBY APPROVE THESE PLANS AND DECLARE THAT THE MAKING OF THIS IMPROVEMENT WILL REQUIRE THE CLOSING TO TRAFFIC OF THE HIGHWAY AND THAT PROVISIONS FOR THE MAINTENANCE AND SAFETY OF TRAFFIC WILL BE AS SET FORTH ON THE PLANS AND ESTIMATES.

INDEX OF SHEETS:

TITLE SHEET	1
CENTER LINE LOCATION MAP	2
GENERAL NOTES	3
ASPHALT CONCRETE	4-5
BRIDGE TREATMENTS	6
TRAFFIC CONTROL SUBSUMMARY	7
GENERAL SUMMARY	8

UNDERGROUND UTILITIES
 CONTACT BOTH SERVICES
 CALL TWO WORKING DAYS
 BEFORE YOU DIG

CALL
1-800-362-2764
 (TOLL FREE)

OHIO UTILITIES PROTECTION SERVICE
 NON-MEMBERS
 MUST BE CALLED DIRECTLY

OIL & GAS PRODUCERS UNDERGROUND
 PROTECTION SERVICE CALL: **1-800-925-0988**

DESIGN EXCEPTIONS
 NONE REQUIRED



PLANS PREPARED BY:
 ATHENS COUNTY ENGINEER'S OFFICE
 16000 CANAANVILLE RD
 ATHENS, OHIO 45701

ENGINEER'S SEAL	STANDARD CONSTRUCTION DRAWINGS	SUPPLEMENTAL SPECIFICATIONS
	BP-3.1 1-21-22	SS-800 4-22-22
	BP-4.1 7-19-13	SS-832 10-19-18
SIGNED: <i>Rex Maiden</i> DATE: 3/11/22	MT-97.12 1-20-17	SPECIAL PROVISIONS
	MT-101.60 1-17-20	
	MT-105.10 1-17-20	

APPROVED *Lenny Elchin*
 DATE 3/17/22 ATHENS COUNTY COMMISSIONER

FEDERAL PROJECT NO. E220156
 PID NO. 115576
 CONSTRUCTION PROJECT NO.
 RAILROAD INVOLVEMENT NONE
 ATH CR VAR RESURF FY23
 1/8

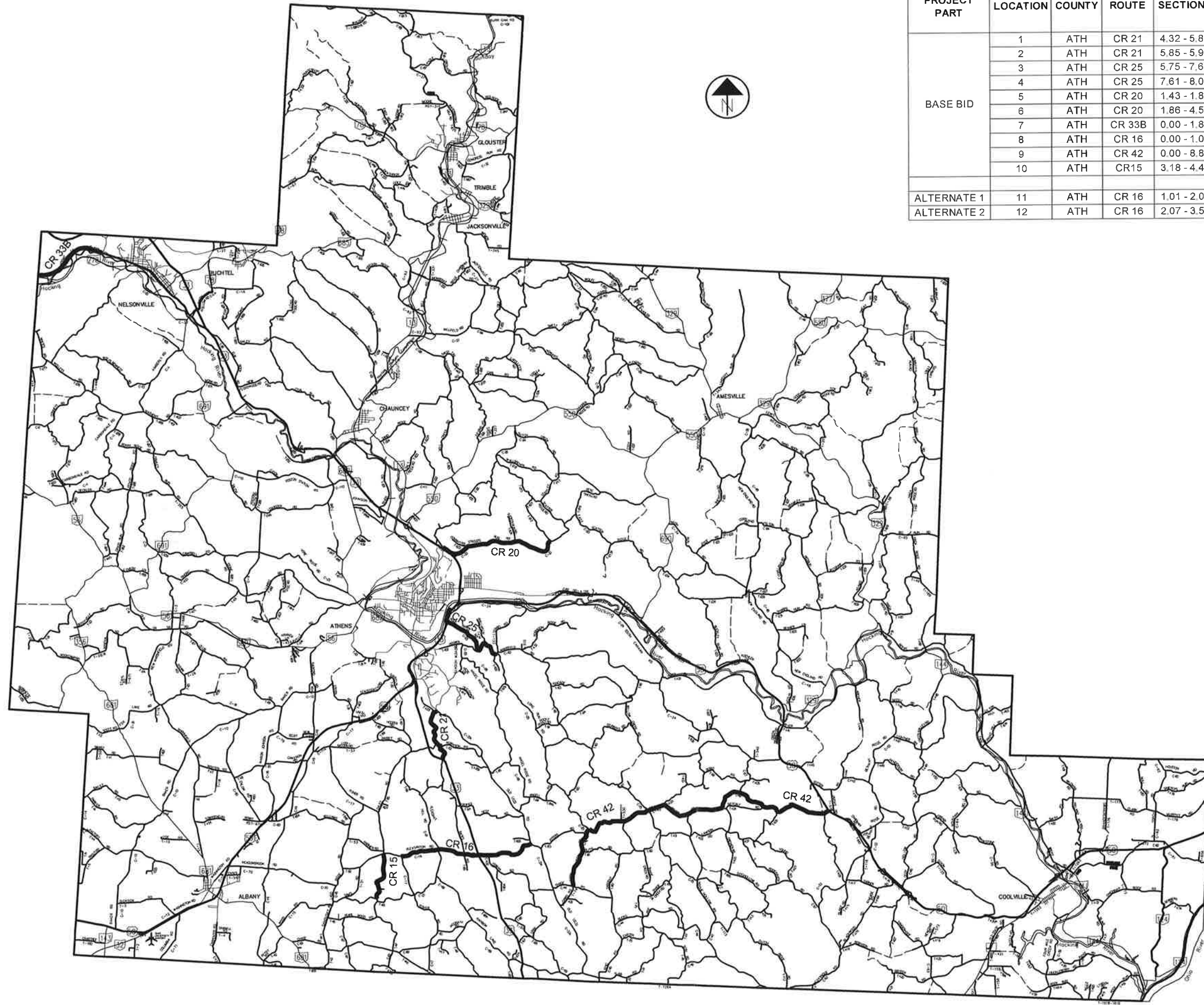

PROJECT PART	LOCATION	COUNTY	ROUTE	SECTIONS	PROJECT TERMINI		NET LENGTH MILES	PARTICIPATION SPLIT
					BEGIN	END		
BASE BID	1	ATH	CR 21	4.32 - 5.85	4.32	5.85	1.53	03/NFA/PV
	2	ATH	CR 21	5.85 - 5.98	5.85	5.98	0.13	02/S<2/PV
	3	ATH	CR 25	5.75 - 7.61	5.75	7.61	1.86	03/NFA/PV
	4	ATH	CR 25	7.61 - 8.04	7.61	8.04	0.43	02/S<2/PV
	5	ATH	CR 20	1.43 - 1.86	1.43	1.86	0.43	02/S<2/PV
	6	ATH	CR 20	1.86 - 4.56	1.86	4.56	2.70	01/STR/PV
	7	ATH	CR 33B	0.00 - 1.84	0.00	1.84	1.84	01/STR/PV
	8	ATH	CR 16	0.00 - 1.01	0.00	1.01	1.01	01/STR/PV
	9	ATH	CR 42	0.00 - 8.80	0.00	8.80	8.80	01/STR/PV
	10	ATH	CR 15	3.18 - 4.49	3.18	4.49	1.31	01/STR/PV
ALTERNATE 1	11	ATH	CR 16	1.01 - 2.07	1.01	2.07	1.06	01/STR/PV
ALTERNATE 2	12	ATH	CR 16	2.07 - 3.59	2.07	3.59	1.52	01/STR/PV

CALCULATED
DES
CHECKED
RJM

CENTER LINE LOCATION MAP

ATH CR VAR
RESURF FY23

UTILITIES

THERE ARE NO UNDERGROUND UTILITIES SHOWN ON THIS PLAN. THE NATURE OF THE WORK REQUIRED BY THIS PROJECT WILL NOT AFFECT ANY KNOWN UNDERGROUND UTILITIES THAT EXIST UNDER OR ADJACENT TO THE WORK AREA.

PROFILE AND ALIGNMENT

PLACE THE PROPOSED PAVEMENT TO FOLLOW THE ALIGNMENT AND PROFILE OF THE EXISTING PAVEMENT. PLACE THE PROPOSED ASPHALT CONCRETE OVERLAYS WITH A UNIFORM THICKNESS AS SHOWN IN THE TYPICAL SECTIONS.

CONSTRUCTION NOTIFICATION

THE CONTRACTOR WILL ADVISE THE PROJECT ENGINEER A MINIMUM OF TWENTY-ONE (21) DAYS PRIOR TO THE FOLLOWING: THE START OF CONSTRUCTION ACTIVITIES, LANE RESTRICTIONS, LANE CLOSURES, AND/OR ROAD CLOSURES.

ITEM 614 - MAINTAINING TRAFFIC

TRAFFIC WILL BE MAINTAINED AT ALL TIMES DURING HOT MIX OVERLAYS. THE LENGTH OF THE RESTRICTED TRAFFIC ZONES WILL BE KEPT TO A MINIMUM CONSISTENT WITH THE SPECIFICATION REQUIREMENTS FOR THE PROTECTION OF THE COMPLETED COURSE.

ALL WORK AND TRAFFIC CONTROL DEVICES SHALL BE IN ACCORDANCE WITH CMS 614 AND OTHER APPLICABLE PORTIONS OF THE SPECIFICATIONS, AS WELL AS THE OHIO MANUAL OF UNIFORM TRAFFIC CONTROL DEVICES. PAYMENT FOR ALL LABOR, EQUIPMENT, AND MATERIALS SHALL BE INCLUDED IN THE LUMP SUM CONTRACT PRICE FOR ITEM 614, MAINTAINING TRAFFIC, UNLESS SEPARATELY ITEMIZED IN THE PLAN.

ROAD CLOSED/MAINTENANCE OF TRAFFIC - MOTOR PAVING/CHIP SEAL

DUE TO THE NATURE OF "FULL-WIDTH PAVING" FOR THE MOTOR PAVING AND CHIP SEAL, THE CONTRACTOR MAY CLOSE THE ROAD BUT MUST ALLOW ACCESS FOR EMERGENCY VEHICLES AND LOCAL RESIDENTS AS NEEDED.

LANE WIDTH

CARE SHALL BE TAKEN TO ENSURE THE CENTERLINE STRIPING IS IN THE ACTUAL CENTER OF THE PAVEMENT. WHERE EDGE LINE IS REQUIRED, THE LANE WIDTH SHALL BE MAXIMIZED OR PLACED WHERE EXISTING EDGE LINE IS LOCATED.

CENTER LINE MARKINGS AT INTERSECTIONS

WHERE AN INTERSECTION IS LOCATED IN A CURVE OF A ROADWAY, THE CENTER LINE SHALL BE EXTENDED THROUGH THE INTERSECTION AND BE DOUBLE LINE DOTTED WITH TWO (2) FOOT SEGMENTS AND FOUR (4) FOOT GAPS.

ITEM 623. CONSTRUCTION LAYOUT STAKES AND SURVEYING, AS PER PLAN

WHEN STATIONING A RESURFACING PROJECT FOR QUANTITY CONTROL, THE REFERENCE IN 623.02 TO A REGISTERED PROFESSIONAL ENGINEER OR REGISTERED PROFESSIONAL SURVEYOR SHALL BE WAIVED. THE STAKES MAY BE PLACED BY THE CONTRACTOR'S PERSONNEL USING A MEASURING WHEEL.

MAILBOX TURNOUTS

AN ESTIMATED QUANTITY OF ASPHALT CONCRETE HAS BEEN PROVIDED FOR THE PURPOSE OF PAVING MAILBOX TURNOUTS THROUGHOUT THE LIMITS OF THE PROJECT. THE ASPHALT CONCRETE FOR TURNOUTS WILL BE THE SAME AS THE OVERLAY COURSE WITH THE THICKNESS AT 1.50 INCH MIN. A TURNOUT WILL BE CONSTRUCTED AT EACH MAILBOX ENCOUNTERED WITHIN THE PROJECT LIMITS AS PER STD. DWG. BP-4.1. IT IS INTENDED THAT THE WIDTH OF THE TURNOUT BE A MAXIMUM OF SIX (6) FEET, MEASURED FROM THE EDGE OF PAVEMENT OR PAVED BERM OR THE DISTANCE TO THE FACE OF GUARDRAIL. IF THE MAILBOX IS BEHIND GUARDRAIL, THE WIDTH WILL BE DECREASED TO EQUAL THE ACTUAL DISTANCE BETWEEN THE EDGE OF PAVEMENT OR PAVED BERM AND THE FACE OF GUARDRAIL.

PRIVATE DRIVES & SIDE ROADS (HOTMIX OVERLAYS)

PRIVATE DRIVES (EXCEPT FIELD DRIVES) WILL BE WEDGE PAVED (HOT MIX) THREE (3) FEET FROM THE EDGE OF PAVEMENT, AND NO MORE THAN THIRTY-FIVE (35) FEET IN WIDTH FOR EACH DRIVE. SIDE ROADS WILL BE WEDGE PAVED TO MEET THE EXISTING AS DIRECTED BY THE ENGINEER.

MOTOR PAVE CONSTRUCTION DETAILS

THE CONTRACTOR MUST USE A SELF-PROPELLED MOTOR PAVER. CONTROL OF THE SCREED OF STRIKE-OFF POSITION SHALL BE INDEPENDENT OF IRREGULARITIES IN THE UNDERLYING SURFACE AND OF SPREADER OPERATION TO MAINTAIN PROPER PROFILE. A FULL-WIDTH (APPROXIMATELY 18'-20' SCREED) PAVER SHALL BE USED. THE ROAD WILL BE CLOSED TO TRAFFIC DURING WORK HOURS.

ALL ROAD SURFACES SHALL BE SWEEPED BEFORE COMMENCEMENT OF WORK.

MATERIALS TO BE USED ARE AS FOLLOWS: AGGREGATE: #57 LIMESTONE (150 LBS. PER SQUARE YARD), EMULSION: MC800 (10.0 GALLONS PER TON OF 57'S), CHOKE AGGREGATE: #9 GRAVEL/GRITS (10 LBS. PER SQUARE YARD). HAUL DISTANCE WILL DETERMINE THE USE OF THE AGGREGATE VENDOR. PAVEMENT LAYER IS TO BE AN AVERAGE OF TWO AND HALF (2.5) INCHES THICK.

THE CONTRACTOR SHALL MAINTAIN THE COLD MIX DESIGN AND THE RATE OF APPLICATION OF THE COLD MIX AS SPECIFIED. THERE SHALL BE NO VARIATION FROM THE SPECIFICATIONS UNLESS A CHANGE BY THE ENGINEER IS DETERMINED TO BE NECESSARY, MIXING TIME OF THE AGGREGATE AND ASPHALT EMULSION SHALL BE AS REQUIRED TO PRODUCE A MIXTURE IN WHICH UNIFORM DISTRIBUTION OF THE ASPHALT EMULSION AND COATING OF THE AGGREGATE IS OBTAINED. AGGREGATE SURFACES SHALL BE OBSERVED FOR MOISTURE TO ASSURE THAT AN ACCEPTABLE COATING OF ASPHALT MATERIAL MAY BE OBTAINED. COLD MIX SHALL NOT BE PLACED WHEN THE SURFACE IS WET AND /OR WHEN WEATHER CONDITIONS OTHERWISE PREVENT PROPER HANDLING, FINISHING, OR CUTTING OF THE MIXTURE. EMULSION THAT FAIL TO PERFORM SATISFACTORILY IN THE FIELD WITH PAVING EQUIPMENT AND WITH THE AGGREGATE SHALL BE IMMEDIATELY REPORTED TO THE ENGINEER.

ALL COLD MIX APPLICATIONS ON ALL ROADS IN THIS CONTRACT SHALL BE ROLLED TO PROPER COMPACTION AS DIRECTED BY THE ENGINEER. CONTRACTORS SHALL ALWAYS USE TWO (2) DRUM STEEL AND PNEUMATIC TIRED ROLLERS. THE FIRST STAGE OF FINISHING SHALL REQUIRE INITIAL ROLLING FOR NECESSARY COMPACTION. IMMEDIATELY FOLLOWING THE INITIAL ROLLING. THE CHOKE AGGREGATE SHALL BE APPLIED UNIFORMLY AT AN APPROXIMATE RATE OF 10 POUNDS PER SQUARE YARD OR AS DIRECTED BY THE ENGINEER. THE SECOND AND FINAL STAGE OF FINISHING SHALL REQUIRE THAT THE FINAL ROLLING BE CONTINUED UNTIL THE CHOKE AGGREGATE IS THOROUGHLY EMBEDDED AND ROLLER MARKS ARE ELIMINATED.

PAVEMENT SHALL BE FEATHERED TWO (2) FEET INTO ALL DRIVEWAYS (WHERE POSSIBLE) AND TEN (10) FEET INTO ALL INTERSECTIONS (WHERE POSSIBLE) AND AT A RATE OF TWENTY FIVE (25) FEET PER INCH OF PAVEMENT THICKNESS AT THE BEGINNING AND THE END OF ALL PAVED SECTIONS.

THE PROJECT INSPECTOR MUST BE ON-SITE BEFORE ANY WORK COMMENCES. DELIVERY TICKETS OR SLIPS FOR EVERY LOAD OF STONE AND ASPHALT DELIVERED AND/OR USED AT THE WORK SITE SHALL BE GIVEN TO THE INSPECTOR. SUCH DELIVERY TICKETS WILL BE USED TO VERIFY THE WORK PERFORMED BY THE CONTRACTOR AND PAY THE CONTRACTOR FOR HIS APPLICATION OF THE COLD MIX MATERIAL.

MOTOR PAVING BID ITEMS

ITEM SPECIAL-MISC.: EMULSION (MC800)
SHALL INCLUDE THE PRICE OF MATERIAL, LABOR, AND EQUIPMENT TO SUPPLY AND PLACE MIX LIQUID IN THE PER GALLON UNIT BID PRICE.

ITEM SPECIAL-MISC.: No. 57 LIMESTONE
SHALL INCLUDE THE PRICE OF MATERIAL, LABOR, AND EQUIPMENT TO SUPPLY AND PLACE THE LIMESTONE IN THE PER TON UNIT BID PRICE.

ITEM SPECIAL-MISC.: No. 9 LIMESTONE
SHALL INCLUDE THE PRICE OF MATERIAL, LABOR, AND EQUIPMENT TO SUPPLY AND PLACE THE LIMESTONE IN THE PER TON UNIT BID PRICE.

CHIP SEAL CONSTRUCTION DETAILS

MATERIAL PLACEMENT: ASPHALT EMULSIONS AND AGGREGATE SHALL BE PLACED ON THE SURFACE OF THE ROADWAY WITH COMPUTER CONTROLLED APPLICATION EQUIPMENT ON BOTH THE DISTRIBUTOR AND THE CHIP SPREADER. THE MATERIALS SHALL BE APPLIED "FULL WIDTH" ON THE DRIVING SURFACE AT THE WIDTHS SPECIFIED, EXCEPTING THOSE ROADWAYS IDENTIFIED AS LESS THAN FULL WIDTH IN THE BIDDING DOCUMENTS.

ALL ROAD SURFACES SHALL BE SWEEPED BEFORE COMMENCEMENT OF WORK.

MATERIALS TO BE USED ARE AS FOLLOWS: AGGREGATE: #8 LIMESTONE (23 LBS. PER SQUARE YARD), EMULSION: AE-90 OR MWS-90 (0.4 GALLONS PER SY). HAUL DISTANCE WILL DETERMINE THE USE OF THE AGGREGATE VENDOR.

EMULSION THAT FAIL TO PERFORM SATISFACTORILY IN THE FIELD WITH PAVING EQUIPMENT AND WITH THE AGGREGATE SHALL BE IMMEDIATELY REPORTED TO THE INSPECTOR. ALL CHIP SEAL APPLICATIONS ON ALL ROADS IN THIS CONTRACT SHALL BE ROLLED TO PROPER COMPACTION AS DIRECTED BY THE ENGINEER. CONTRACTORS SHALL ALWAYS USE PNEUMATIC TIRED ROLLERS.

THE PROJECT INSPECTOR MUST BE ON-SITE BEFORE ANY WORK COMMENCES. DELIVERY TICKETS OR SLIPS FOR EVERY LOAD OF STONE AND ASPHALT DELIVERED AND/OR USED AT THE WORK SITE SHALL BE GIVEN TO THE INSPECTOR. SUCH DELIVERY TICKETS WILL BE USED TO VERIFY THE WORK PERFORMED BY THE CONTRACTOR AND PAY THE CONTRACTOR FOR HIS APPLICATION OF THE COLD MIX MATERIAL.

CHIP SEAL BID ITEMS

ITEM SPECIAL-MISC.: EMULSION (AE-90 OR MWS-90)
SHALL INCLUDE THE PRICE OF MATERIAL, LABOR, AND EQUIPMENT TO SUPPLY AND PLACE MIX LIQUID IN THE PER GALLON UNIT BID PRICE.

ITEM SPECIAL-MISC.: No. 8 LIMESTONE
SHALL INCLUDE THE PRICE OF MATERIAL, LABOR, AND EQUIPMENT TO SUPPLY AND PLACE THE LIMESTONE IN THE PER TON UNIT BID PRICE.

ADDITIONAL ALTERNATE BIDDING

ALL ITEMS NOT IDENTIFIED AS AN ALTERNATE IN THE GENERAL SUMMARY SHALL BE CONSIDERED THE BASE BID FOR THIS PROJECT. THE DEPARTMENT WILL AWARD THE CONTRACT FOR THIS CORE WORK TO THE LOWEST RESPONSIVE BIDDER.

ADDITIONAL FUNDING MAY BE AVAILABLE FOR ITEMS LABELED AS "ALTERNATE 1 OR ALTERNATE 2" IN ADDITION TO THE BASE BID ITEMS. CONTRACTORS SHALL SUBMIT ADDITIONAL ALTERNATE BIDS FOR THIS WORK. WHEN BIDS ARE OPENED, IF THE BASE BID DOES NOT EXCEED THE BUDGET LIMIT TO AWARD THE PROJECT, THE BASE BID AND ALTERNATE 1 WILL THEN BE CONSIDERED. IF THIS COMBINATION STILL DOESN'T EXCEED THE LIMIT, THE BASE BID AND ALTERNATE 1 AND ALTERNATE 2 WILL THEN BE CONSIDERED.

THE BID BUDGET FOR THIS PROJECT IS \$ 2,628,560.00.

ASPHALT CONCRETE

SIGN	LOC 1	LOC 2	LOC 3	LOC 4	LOC 5	LOC 6	LOC 7
R4-1	3	1	2	2	1	5	4
TOTAL	3	1	2	2	1	5	4

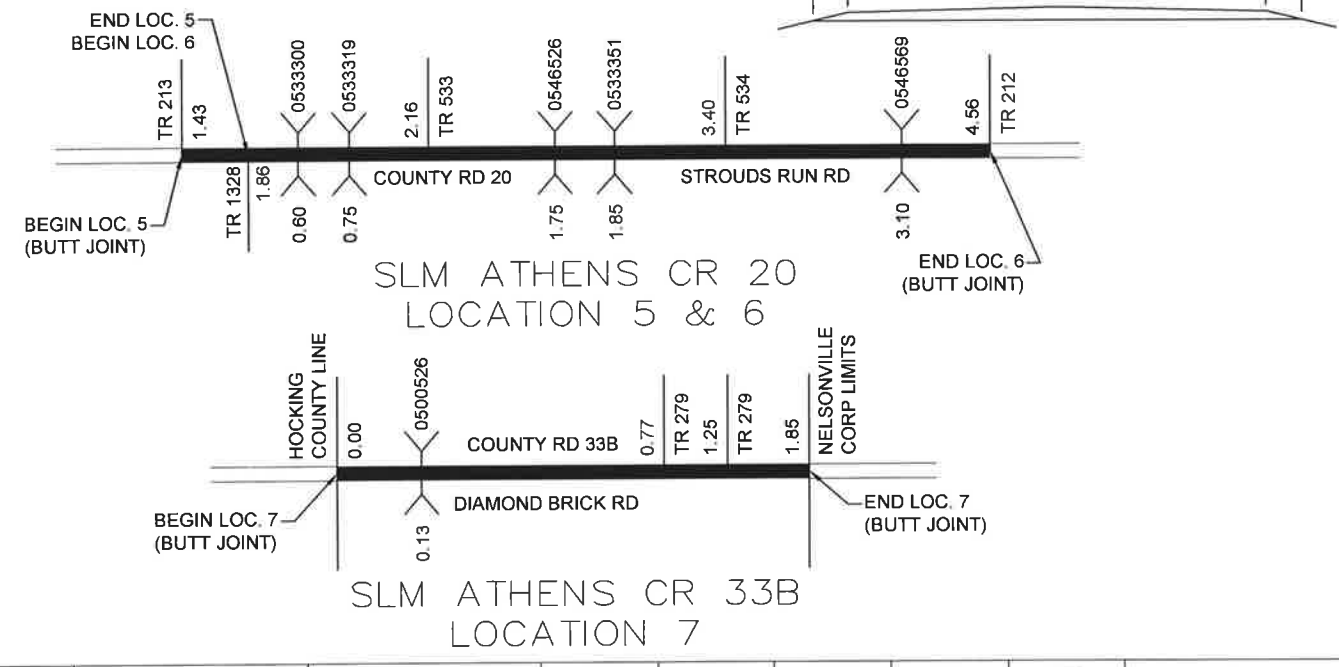
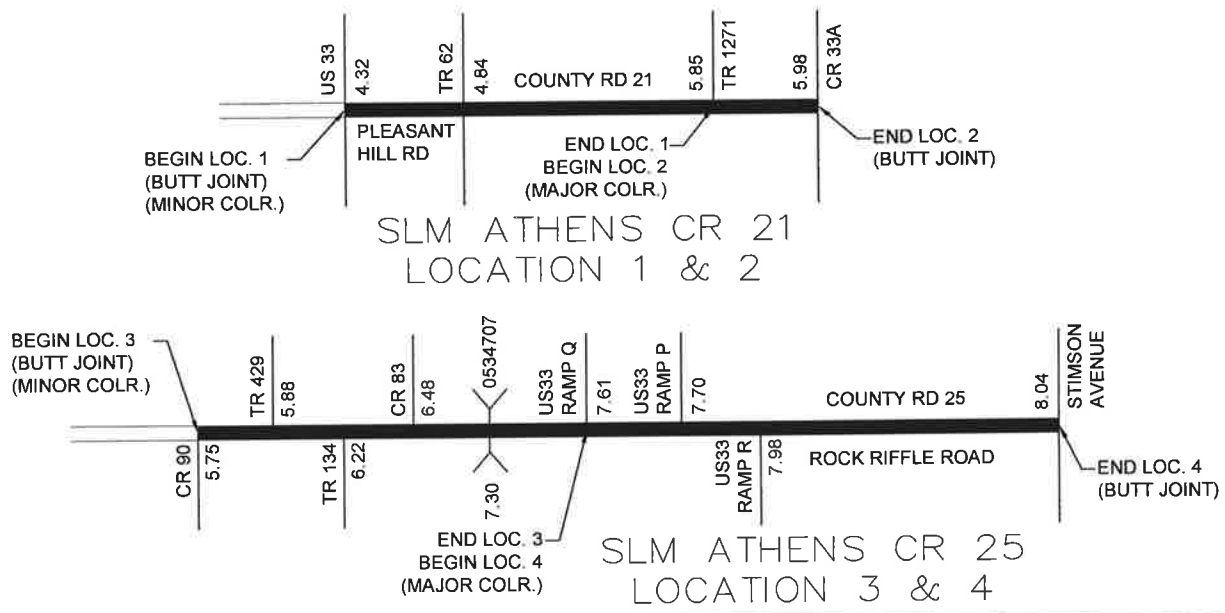
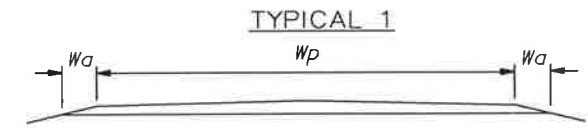

PROJECT PART	LOCATION	ROUTE	SLM		LENGTH		Wp	TYPICAL	PAVEMENT AREA	254		407		407		441		441		690		690		690		690		617	
			FROM	TO	MILE	FEET				FEET	SQ. YD.	PAVEMENT PLANING, ASPHALT CONCRETE	TACK COAT (0.07 Gal/SY)	TACK COAT (0.05 Gal/SY) INTERMEDIATE	ASPHALT CONCRETE INTERMEDIATE COURSE, TYPE 1, (448), PG64-22	INCH	CU. YD.	ASPHALT CONCRETE SURFACE COURSE, TYPE 1, (448), PG64-22	INCH	CU. YD.	TON	EMULSION (MC800MP) (10 GAL/TON)	TON	TON	TON	EMULSION (AE-90 OR MWS-90) (0.42 GAL/SY)	GAL	Wa (FT)	CU. YD.
BASE BID	1	CR 21	4.32	5.85	1.53	8078	19	1	17054	21	1194			1.50	711												1.5	112	
	3 SIDE ROADS @ 70 SY								210	24	15			1.50	9														
	32 DRIVES & MAILBOXES @ 25 SY								800		56			1.50	33														
	SUBTOTALS FOR LOCATION 1										45	1265																	
BASE BID	2	CR 21	5.85	5.98	0.13	686	19	1	1449	21	101			1.50	60												1.5	10	
BASE BID	3	CR 25	5.75	7.61	1.86	9821	20	1	21824	22	1528			1.50	909												1.5	136	
	3 SIDE ROADS @ 70 SY								210	24	15			1.50	9														
	16 DRIVES & MAILBOXES @ 25 SY								400		28			1.50	17														
	SUBTOTALS FOR LOCATION 3										46	1570																	
BASE BID	4	CR 25	7.61	8.04	0.43	2270	25	1	6307	28	441			1.50	263											2	35		
3 SIDE ROADS @ 70 SY									210	24	15			1.50	9														
2 DRIVES & MAILBOXES @ 25 SY									50		4			1.50	2														
SUBTOTALS FOR LOCATION 4										52	460																		
BASE BID	5	CR 20	1.43	1.86	0.43	2270	22	1	5550	24	388	277	1.00	154	1.25	193										1.5	47		
BASE BID	6	CR 20	1.86	4.56	2.70	14256	22	1	34848	24	2439	1742	1.00	968	1.25	1210										1.5	297		
	3 SIDE ROADS @ 70 SY								210	24	15	11	1.00	6	1.25	7													
	26 DRIVES & MAILBOXES @ 25 SY								650		46	33	1.00	18	1.25	23													
	SUBTOTALS FOR LOCATION 6										48	2500	1785		992		1240												
BASE BID	7	CR 33B	0.00	1.84	1.84	9715	30	1	32384	67	2267	1619	1.00	900	1.25	1124										2	240		
	1 SIDE ROADS @ 70 SY								70	8	5	4	1.00	2	1.25	2													
	11 DRIVES & MAILBOXES @ 25 SY								275		19	14	1.00	8	1.25	10													
	SUBTOTALS FOR LOCATION 7										75	2291	1636		909		1136												

CALCULATED DES CHECKED RJM
ASPHALT CONCRETE
 ATH CR VAR
 RESURF FY23
4
8

SIGN	LOC 8	LOC 9	LOC 10	LOC 11	LOC 12
R4-1	2	10	2	2	4
TOTAL	2	10	2	2	4

ASPHALT CONCRETE

TYPICAL 1

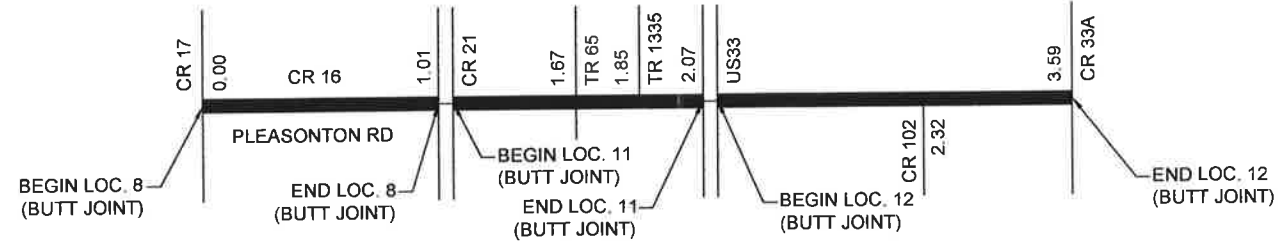
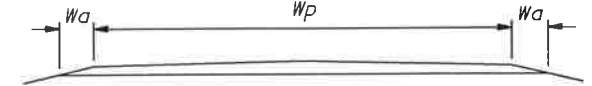

SLM ATHENS CR 16
LOCATION 8, 11, & 12

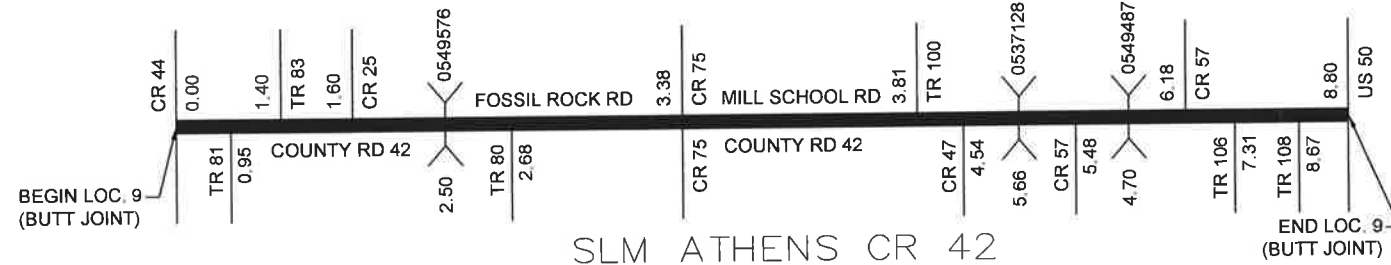

SLM ATHENS CR 42
LOCATION 9

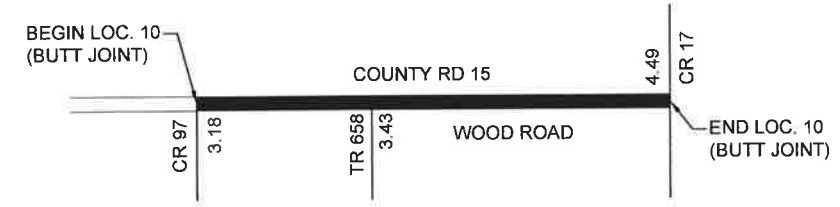

SLM ATHENS CR 15
LOCATION 10

PROJECT PART	LOCATION	ROUTE	SLM		LENGTH		Wp	TYPICAL	PAVEMENT AREA	254		407		407		441		441		690		690		690		690		617									
			FROM	TO	MILE	FEET				SQ. YD.	PAVEMENT PLANING, ASPHALT CONCRETE	TACK COAT (0.07 Gal/SY)	TACK COAT (0.05 Gal/SY) INTERMEDIATE	ASPHALT CONCRETE INTERMEDIATE COURSE, TYPE 1, (448), PG64-22	ASPHALT CONCRETE SURFACE COURSE, TYPE 1, (448), PG64-22	#57 (150#/SY)	EMULSION (MC800MP) (10 GAL/TON)	#9 (10#/SY)	#8 (23#/SY)	EMULSION (AE-90 OR MWS-90) (0.42 GAL/SY)	COMPACTED AGGREGATE	Wa (FT)	CU.YD.														
BASE BID	8	CR 16	0.00	1.01	1.01	5333	20.0	1	11851	133	830																										
	0 SIDE ROADS @ 70 SY										0																										
	11 DRIVES & MAILBOXES @ 25 SY										275	19																									
	SUBTOTALS FOR LOCATION 8										133	849																									
BASE BID	9	CR 42	0.00	8.80	8.80	46443	18	1	92886	20											6966	69664	464	1068	39012												
	10 SIDE ROADS @ 30 SY										300	24										23	225	2	3	126											
	62 DRIVES & MAILBOXES @ 10 SY										620											47	465	3	7	260											
	SUBTOTALS FOR LOCATION 9										44											7035	70354	469	1079	39398											
BASE BID	10	CR 15	3.18	4.49	1.31	6927	19	1	14624	21											1097	10968	73	168	6142												
	1 SIDE ROADS @ 30 SY										30	24										2	23	0	0	13											
	14 DRIVES & MAILBOXES @ 10 SY										140											11	105	1	2	59											
	SUBTOTALS FOR LOCATION 10										45											1110	11096	74	170	6214											
BASE BID TOTALS CARRIED TO GENERAL SUMMARY										534	13,123											8,145	81,450	543	1,249	45,612					951						
ALTERNATE 1	11	CR 16	1.01	2.07	1.06	5597	20.0	1	12437	133	871																										
	3 SIDE ROADS @ 70 SY										210	15																									
	10 DRIVES & MAILBOXES @ 25 SY										250	18																									
	TOTALS TO GENERAL SUMMARY SHEET - ALTERNATE 1										133	903																									
ALTERNATE 2	12	CR 16	2.07	3.59	1.52	8015	20.0	1	17811	133	1247																										
	1 SIDE ROADS @ 70 SY										70	5																									
	12 DRIVES & MAILBOXES @ 25 SY										300	21																									
	TOTALS TO GENERAL SUMMARY SHEET - ALTERNATE 2										133	1273																									

CALCULATED DES CHECKED RUM
ASPHALT CONCRETE
 ATH CR VAR RESURF FY23
 5/8

ALL STRUCTURES NOT LISTED BELOW ARE TO BE PAVED OVER.



BRIDGE NOTES

LOCATION 6:

ATH-CR20-1.75 - MILL 2.25-INCHES OFF DECK AND EXISTING PAVEMENT 25-FEET AT EACH END.

ATH-CR20-1.85 - MILL 2.25-INCHES OFF DECK AND EXISTING PAVEMENT 25-FEET AT EACH END.

BRIDGE DECK DATA

PROJECT PART	LOCATION	COUNTY, ROUTE, BRIDGE NO.	SFN	EXISTING SURFACE	LENGTH (BRIDGE LIMITS)		BRIDGE DECK AREA	PROPOSED WORK	254			
					FT	FT			SQ. YD.	PAVEMENT PLANING REMOVED DEPTH		
BASE BID	3	ATH-CR25-7.30	0534707	ASPHALT	21	24	56	OVERLAY	0			
	6	ATH-CR20-0.60	0533300	ASPHALT	24	23	61	OVERLAY	0			
		ATH-CR20-0.75	0533319	ASPHALT	23	28	72	OVERLAY	0			
		ATH-CR20-1.75	0546526	ASPHALT	22	24	59	MILL 2.25" AND OVERLAY	175.3			
		ATH-CR20-1.85	0533351	ASPHALT	22	24	59	MILL 2.25" AND OVERLAY	175.3			
		ATH-CR20-3.10	0546569	ASPHALT	14	24	37	OVERLAY	0			
	7	ATH-CR33B-0.13	0500526	ASPHALT	19	30	63	OVERLAY	0			
	9	ATH-CR42-2.50	0549576	ASPHALT	62	24	165	OVERLAY	0			
		ATH-CR42-5.66	0537128	ASPHALT	17	23	43	OVERLAY	0			
		ATH-CR57-4.70	0549487	ASPHALT	25	23	64	OVERLAY	0			
TOTALS TO GENERAL SUMMARY SHEET - BASE BID									351			

PROJECT PART	LOCATION	ROUTE	SLM		614	614		621		642	642		644	REMARKS
			FROM	TO	WORK ZONE CENTER LINE, CLASS II, 642 PAINT	WORK ZONE MARKING SIGN		RAISED PAVEMENT MARKER REMOVED		EDGE LINE, 4 INCH, TYPE 1	CENTER LINE, TYPE 1		STOP LINE	
					MILE	EACH		EACH		MILE	MILE		FT	
BASE BID	1	CR 21	4.32	5.85	1.53	3				3.06	1.53		12	
	2	CR 21	5.85	5.98	0.13	1				0.26	0.13		12	
	3	CR 25	5.75	7.61	1.86	2				3.72	1.86		12	
	4	CR 25	7.61	8.04	0.43	2				0.86	0.43		12	
	5	CR 20	1.43	1.86	0.86	1				0.86	0.43		12	
	6	CR 20	1.86	4.56	5.40	5				5.40	2.70			
	7	CR 33B	0.00	1.84	3.68	4		240		3.68	1.84		60	
	8	CR 16	0.00	1.01	1.01	2					1.01		24	
	9	CR 42	0.00	8.80	0.00	10					8.80		200	
	10	CR 15	3.18	4.49	0.00	2					1.31		24	
TOTALS TO GENERAL SUMMARY SHEET - BASE BID					14.90	32		240		17.84	20.04		368	
ALTERNATE 1	11	CR 16	1.01	2.07	1.06	2					1.06		24	
TOTALS TO GENERAL SUMMARY SHEET - ALTERNATE 1					1.06	2					1.06		24	
ALTERNATE 2	12	CR 16	2.07	3.59	1.52	2					1.52		24	
TOTALS TO GENERAL SUMMARY SHEET - ALTERNATE 2					1.52	2					1.52		24	

CALCULATED
DES
CHECKED
RJM

TRAFFIC CONTROL SUBSUMMARY

ATH CR VAR
RESURF FY23

SHEET NUM.							PART.			ALT (X)	ITEM	ITEM EXT	GRAND TOTAL	UNIT	DESCRIPTION	SEE SHEET NO.
3	4	5	6	7	01/STR/ PV	02/S<2/ PV	03/NFA/ PV									
														BASE BID		
														PAVEMENT		
		534	351			697	97	91		254	01000	885	SY	PAVEMENT PLANING, ASPHALT CONCRETE		
		13,123				9,062	1,226	2,835		407	10000	13,123	GAL	TACK COAT		
		5,096				2,881	527	1,688		441	50000	5,096	CY	ASPHALT CONCRETE SURFACE COURSE, TYPE 1, (448), PG64-22		
		2,055				1,901	154			441	50200	2,055	CY	ASPHALT CONCRETE INTERMEDIATE COURSE, TYPE 1, (448)		
		951				611	92	248		617	10100	951	CY	COMPACTED AGGREGATE		
		8,145				8,145				SPECIAL	69098800	8,145	TON	No. 57 LIMESTONE		
		543				543				SPECIAL	69098800	543	TON	No. 9 LIMESTONE		
		1,249				1,249				SPECIAL	69098800	1,249	TON	No. 8 LIMESTONE		
		81,450				81,450				SPECIAL	69098900	81,450	GAL	EMULSION (MC800)		
		45,612				45,612				SPECIAL	69098900	45,612	GAL	EMULSION (AE-90 OR MWS-90)		
														TRAFFIC CONTROL		
						23	4	5		614	12460	32	EACH	WORK ZONE MARKING SIGN		
						10.09	1.42	3.39		614	21500	14.9	MILE	WORK ZONE CENTER LINE, CLASS II, 642 PAINT		
						240				621	54000	240	EACH	RAISED PAVEMENT MARKER REMOVED		
						17.84	1.98	6.78		642	00100	17.84	MILE	EDGE LINE, 4", TYPE 1		
						20.04	0.99	3.39		642	00300	20.04	MILE	CENTER LINE, TYPE 1	3	
						368	36	24		644	00500	368	FT	STOP LINE		
														INCIDENTALS		
						0.8	0.15	0.05		614	11000		LS	MAINTAINING TRAFFIC		
						0.8	0.15	0.05		623	10001		LS	CONSTRUCTION LAYOUT STAKES AND SURVEYING, AS PER PLAN	3	
						0.8	0.15	0.05		624	10000		LS	MOBILIZATION		
														ALTERNATE 1		
														PAVEMENT		
		133				133			X	254	01000	133	SY	PAVEMENT PLANING, ASPHALT CONCRETE		
		903				903			X	407	10000	903	GAL	TACK COAT		
		537				537			X	441	50000	537	CY	ASPHALT CONCRETE SURFACE COURSE, TYPE 1, (448), PG64-22		
		78				78			X	617	10100	78	CY	COMPACTED AGGREGATE		
														TRAFFIC CONTROL		
						2			X	614	12460	2	EACH	WORK ZONE MARKING SIGN		
						1.06			X	642	00300	1.06	MILE	CENTER LINE, TYPE 1	3	
						24			X	644	00500	24	FT	STOP LINE		
														INCIDENTALS		
						LS			X	614	11000		LS	MAINTAINING TRAFFIC		
						LS			X	623	10001		LS	CONSTRUCTION LAYOUT STAKES AND SURVEYING, AS PER PLAN	3	
						LS			X	624	10000		LS	MOBILIZATION		
														ALTERNATE 2		
														PAVEMENT		
		133				133			X	254	01000	133	SY	PAVEMENT PLANING, ASPHALT CONCRETE		
		1,273				1,273			X	407	10000	1,273	GAL	TACK COAT		
		758				758			X	441	50000	758	CY	ASPHALT CONCRETE SURFACE COURSE, TYPE 1, (448), PG64-22		
		111				111			X	617	10100	111	CY	COMPACTED AGGREGATE		
														TRAFFIC CONTROL		
						2			X	614	12460	2	EACH	WORK ZONE MARKING SIGN		
						1.52			X	642	00300	1.52	MILE	CENTER LINE, TYPE 1	3	
						24			X	644	00500	24	FT	STOP LINE		
														INCIDENTALS		
						LS			X	614	11000		LS	MAINTAINING TRAFFIC		
						LS			X	623	10001		LS	CONSTRUCTION LAYOUT STAKES AND SURVEYING, AS PER PLAN	3	
						LS			X	624	10000		LS	MOBILIZATION		

CALCULATED DES RJM
 CHECKED RJM
GENERAL SUMMARY
 ATH CR VAR
 RESURF FY23
 8
 8